

Toilet Seat Installation Manual and Operating Instructions

Thank You for Choosing Our Product

Please read carefully the following installation instructions in order to avoid component damage or injury to the installer. Keep the installation manual available for future maintenance or reference.



PRECAUTIONS: Follow all safety precautions to avoid bodily injury or damage to property

 PRECAUTIONS		Do not stand or place heavy objects on the seat cover as the weight could damage the seat and may cause injury.	
		Do not use strong abrasive cleaners as they will scratch and dull the surface. Clean the outside surface of your toilet seat with mild soap water. Wipe the entire surface completely dry with a clean and soft cloth.	
		Keep children out of reach of the seat to avoid injury	

Care Instructions

Do not open/close the seat cover using excessive force. Doing so may cause cracks or failure of performance.

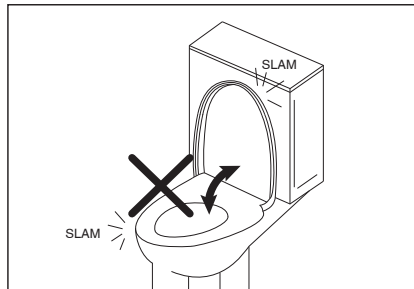

The closing speed of the seat with slow close function can vary with the changing of room temperature and use cycles.

Do not expose the product to direct sunlight. Doing so may cause colour fading.

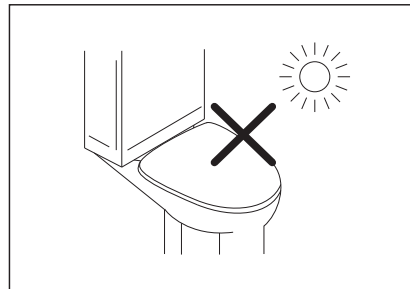

Installation Instructions

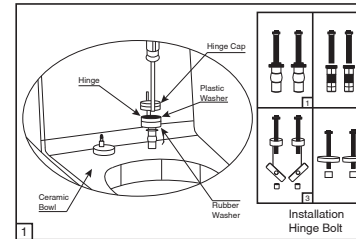

1. Insert the rubber expansion nut into the bowl bolt holes, then install the hinge, plastic washer and bolt into the hinge holes. Using a screwdriver, tighten the bolt into the rubber expansion nuts and close the hinge cap

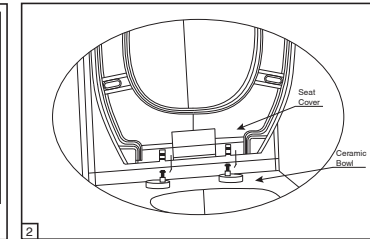

2. Attached the seat cover into the hinge bar as per drawing

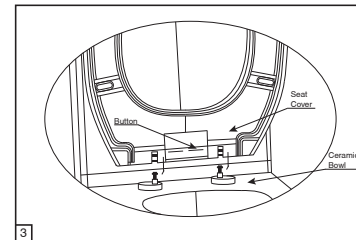

3. Slightly press the hinge cap and lift the seat cover to separate from the hinge

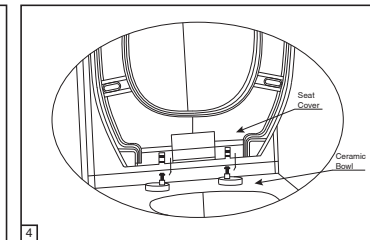

4. Close the hinge cap and re-attach the seat into the hinge

Maintenance Instructions

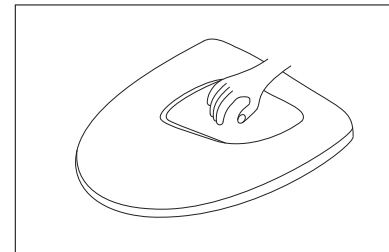

1. Periodical Maintenance

- Wash the toilet seat with a soft, wet cloth
- Dry with soft dry cloth

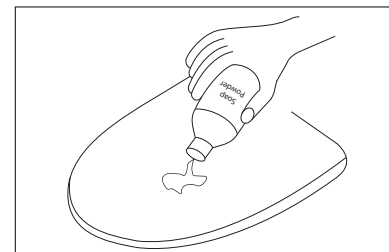

2. Removal of Stains

- Use neutral detergent (eg soap powder) to wipe softly then dry with clean cloth
- Do not use eradicator, abrasive powder, diluent, volatile oil, acid or alkali liquid detergent or nylon brush to clean the product to avoid damage