

DIMAX DUCTILE IRON DN80-300 AS/NZS 2280 FITTINGS

Flange Dimensions to AS/NZS 4087
TYTON® Socket



RANGE OVERVIEW

DIMAX Ductile Iron fittings offer high strength and impact resistance.

It is suitable for both 'above ground' and 'in ground' installations.

All DIMAX fittings are manufactured with a high quality thermally bonded polymeric coating for superior corrosion protection and service life.

The TYTON® socket profile provides the flexibility of using TYTON® gaskets for ductile iron OD compatible pipes, PLASTYT gaskets for series 1 PVC pipes or TYTON-LOK® gaskets for restrained joints.

TYTON® Joints can be deflected and permits axial movement to compensate for thermal expansion and contraction. DN100 - 300 has an allowance for 5 degrees maximum deflection.

Flange joints are self anchoring and don't require external anchorages.

Uses a single cast manufacturing method for optimal strength.

All flange dimensions comply with AS/NZS 4087.

Alternate flange dimensions are available on request.

DESCRIPTION

DIMAX high strength Ductile Iron Flanged and TYTON® JOINT Fittings are manufactured to AS/NZS 2280. The DIMAX Fittings are available in an ever-growing range of sizes and configurations for pipeline construction in both above and below ground applications.

GENERAL APPLICATION

DIMAX Flanged Fittings are used to provide restrained non-flexible joints in pipelines or as part of a pipework arrangement. Flanged Ductile Iron Fittings are commonly used in above ground applications such as a water treatment plant and pump stations.

TYTON® JOINT offer a secure push joint installation with a small amount of deflection to allow for axial movement. Socketed Ductile Iron Fittings are commonly used in below ground applications such as a water trunk main branches.

TECHNICAL DATA

Size Range

DN 80 - DN 300

Allowable Operating Pressure

1600kPa

Maximum Temperature

70° for water and most neutral liquids

End Connection

Flanged to AS/NZS 4087
TYTON® Socket
Spigot

Certification

AS/NZS 2280
AS/NZS 4020
AS/NZS 4087
AS/NZS 4158
WSAA PA 1924



DIMAX DUCTILE IRON DN80-300 AS/NZS 2280 FITTINGS



Flanged Bends

NOMINAL SIZE DN	r	Dimensions b			
		90°	45°	22.5°	11.25°
80	140	229	-	-	-
100	152	241	152	152	152
150	190	279	190	190	190
200	203	305	203	-	-
250	254	365	254	-	-
300	305	406	305	-	-

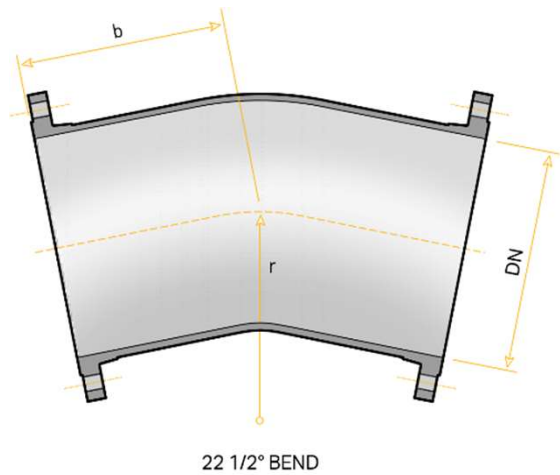
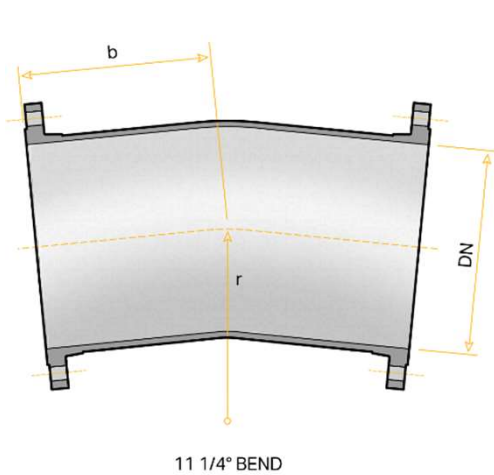
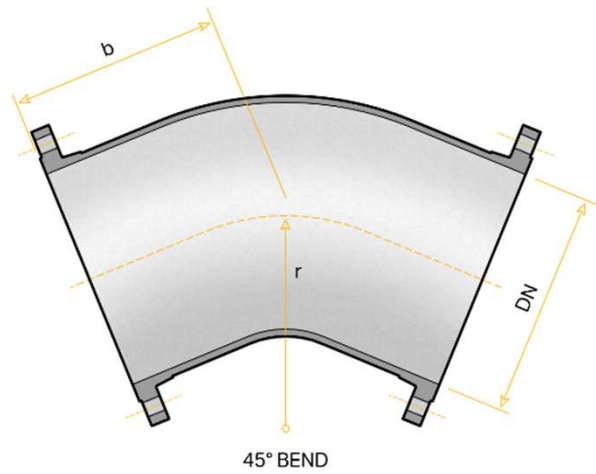
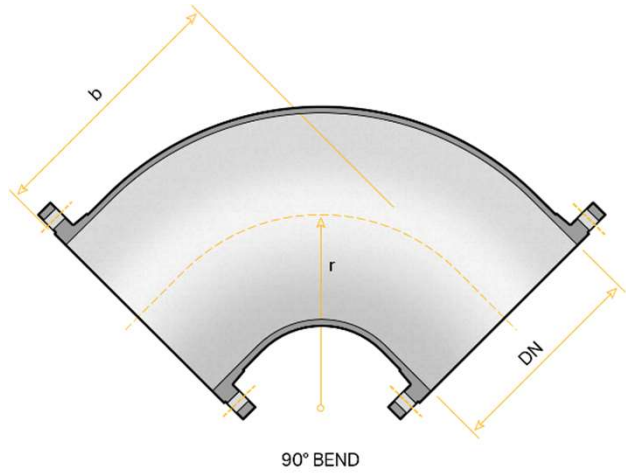

DIMAX DUCTILE IRON DN80-300 AS/NZS 2280 FITTINGS

TYTON® Socket Bends



NOMINAL SIZE DN	r	Dimensions b			
		90°	45°	22.5°	11.25°
100	75	90	45	25	20
150	120	130	60	35	25

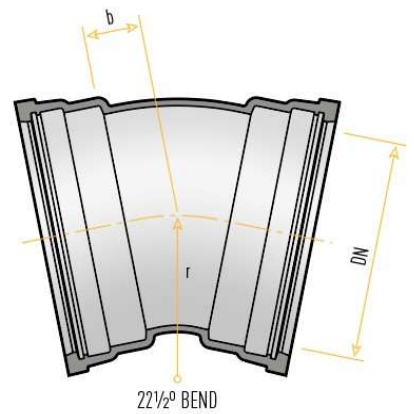
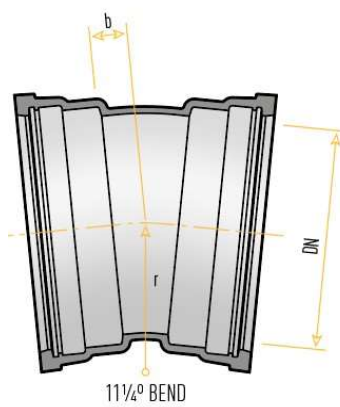
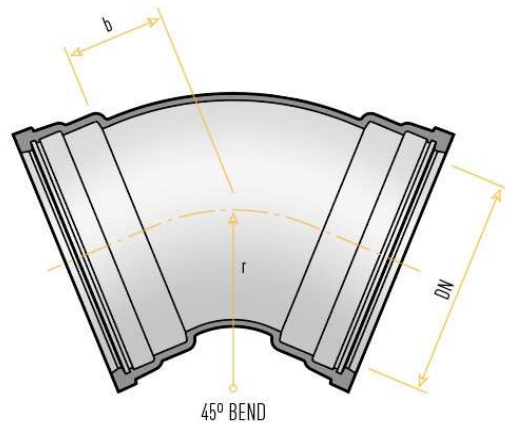
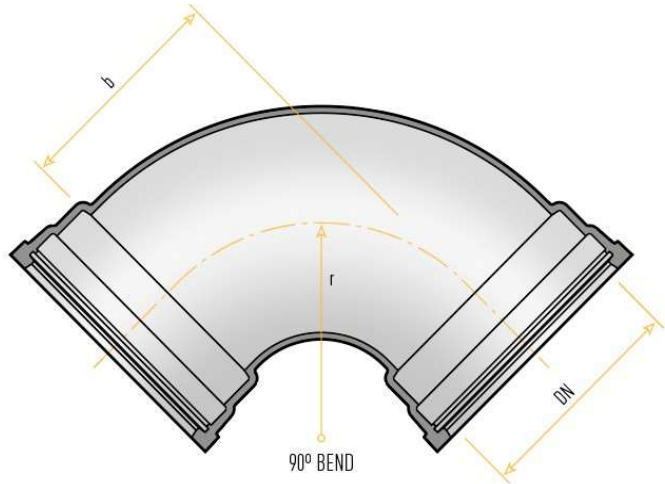

DIMAX DUCTILE IRON DN80-300 AS/NZS 2280 FITTINGS



TYTON® Socket and Flange Bends

Washout Bend

NOMINAL SIZE		b	h
DN	dn		
100	100	195	200
150	100	160	200
150	150	205	279

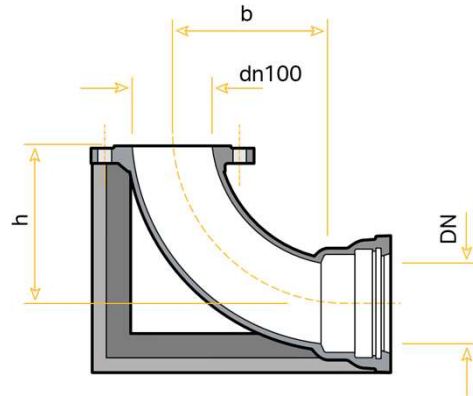

Hydrant Bend

NOMINAL SIZE		b	h
DN	dn		
100	80	205	215
150	80	280	245

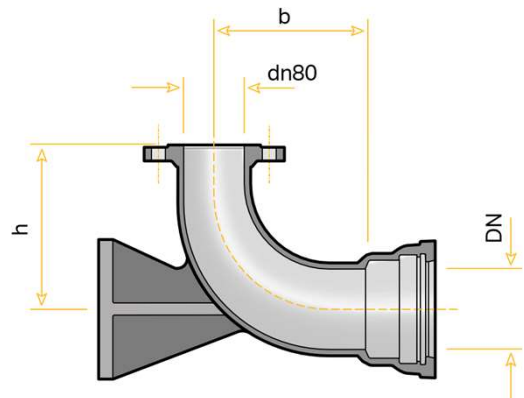

Duckfoot Bend

NOMINAL SIZE		b	h	w
DN	dn			
100	100	241	133	185
150	150	279	165	190

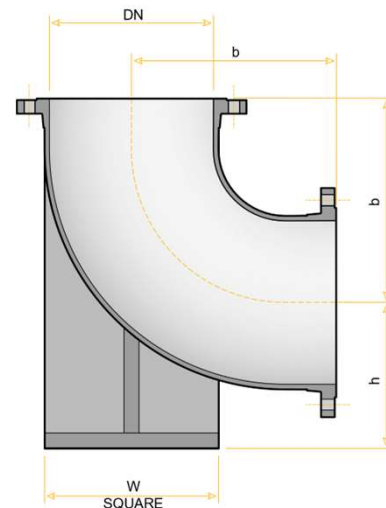

DIMAX DUCTILE IRON DN80-300 AS/NZS 2280 FITTINGS

Connectors



NOMINAL SIZE DN	Dimensions	
	c	L ₁
100	110	205
150	135	205
200	135	230
225	-	230
250	-	230
300	-	255

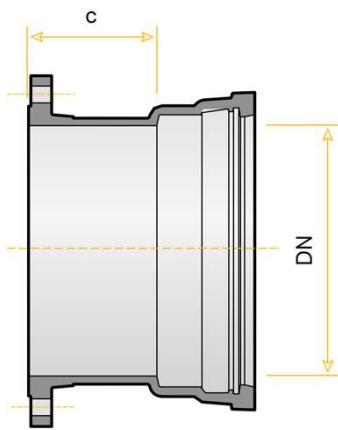

FLANGE - SOCKET

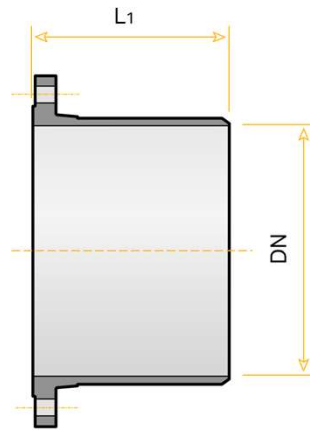

FLANGE - SPIGOT

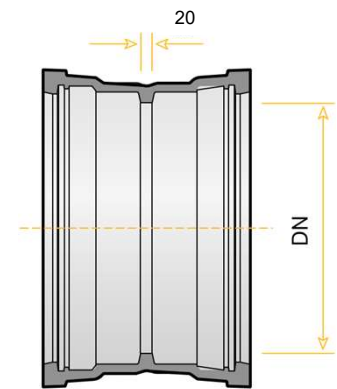

SOCKET - SOCKET

DIMAX DUCTILE IRON DN80-300 AS/NZS 2280 FITTINGS

TYTON® Socket End Cap



NOMINAL SIZE DN	Dimensions	
	f	t
100	129	19
150	139	19

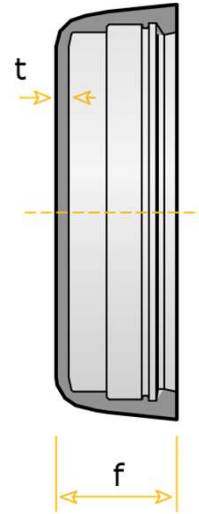

DIMAX DUCTILE IRON DN80-300 AS/NZS 2280 FITTINGS



Blank Flanges

NOMINAL SIZE DN	Thickness
80*#	18
100*#	20
150*#	23
200	23
225	24
250	24
300	30

* 2"/50mm BSPF tapping available.
Alternative Flange sizes and tapping available by request

DN80-150 non-circular design

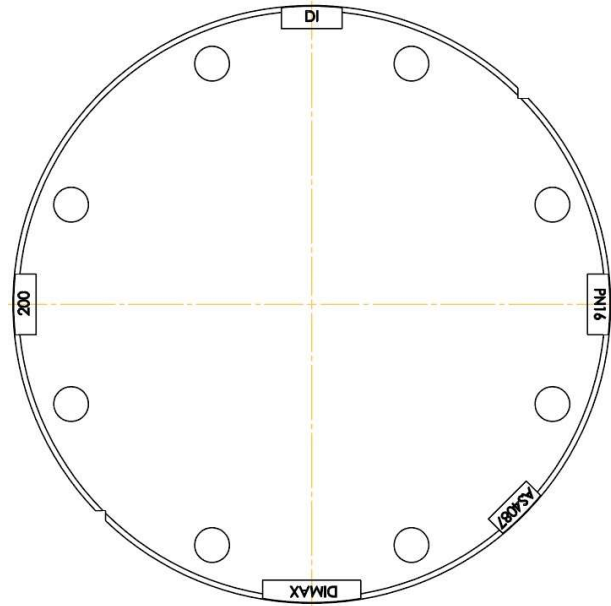

DIMAX DUCTILE IRON DN80-300 AS/NZS 2280 FITTINGS

Hydrant Risers



NOMINAL SIZE DN	L
80	100
80	150
80	225
80	300
80	375
80	450
80	600
100*	
100	100
100	150
100	225
100	300
100	375
100	450
100	500
100	600
150	
150	150
150	225
150	300
150	450
150	600
80/100 Adaptor	
80/100 Adaptor	100
100xDGL	
100xDGL	150

* Open holes one end to allow for ease of installation

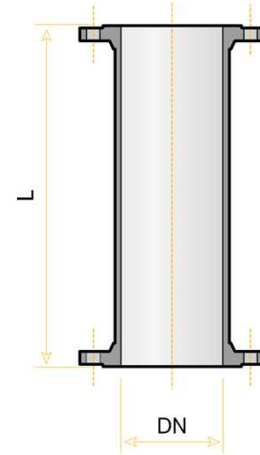

DIMAX DUCTILE IRON DN80-300 AS/NZS 2280 FITTINGS



Reducers / Tapers

Flanged - Concentric

NOMINAL SIZE		
DN	dn	L ₃
100	80	165
150	100	235
200	150	248
250	150	375
250	200	254

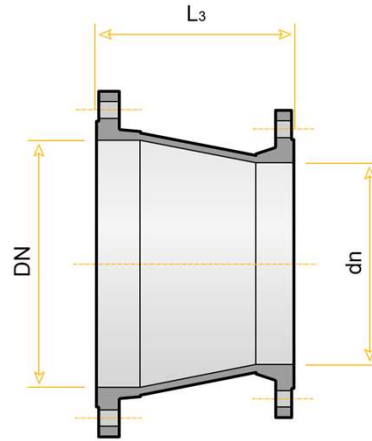

CONCENTRIC

TYTON® Socket

NOMINAL SIZE		
DN	dn	L ₁
150	100	170

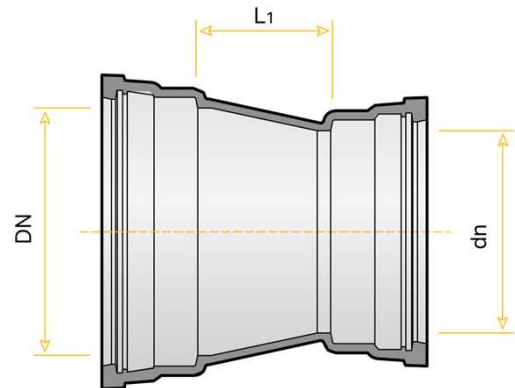

DIMAX DUCTILE IRON DN80-300 AS/NZS 2280 FITTINGS



Flanged Tees

NOMINAL SIZE		Dimensions	
BODY DN	BRANCH dn	h	L
100	80	178	356
100	100	178	356
150	80	203	406
150	100	203	406
150	150	203	406
200	80	241	484
200	100	241	484
200	150	241	484
200	200	241	484
250	250	267	534
300	300	305	610

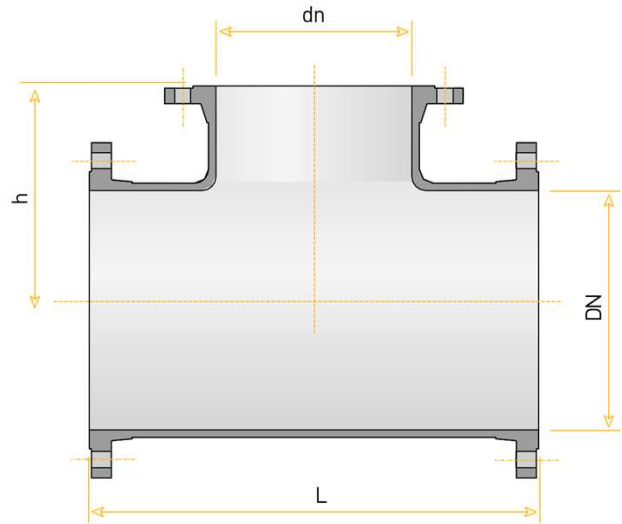

DIMAX DUCTILE IRON DN80-300 AS/NZS 2280 FITTINGS

TYTON® Socket Tees



NOMINAL SIZE		Dimensions	
BODY DN	BRANCH dn	h	L
100	100	68	136
150	100	90	145
150	150	97.5	195

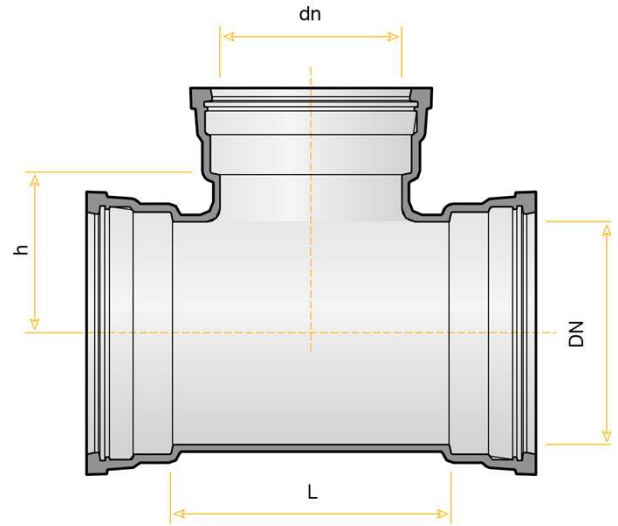

DIMAX DUCTILE IRON DN80-300 AS/NZS 2280 FITTINGS

TYTON® Socket x Flange Tees



NOMINAL SIZE		Dimensions	
BODY DN	BRANCH dn	h	L
100	80	180	150
100	100	180	170
150	80	185	150
150	100	190	170
150	150	195	240
200	80	250	210

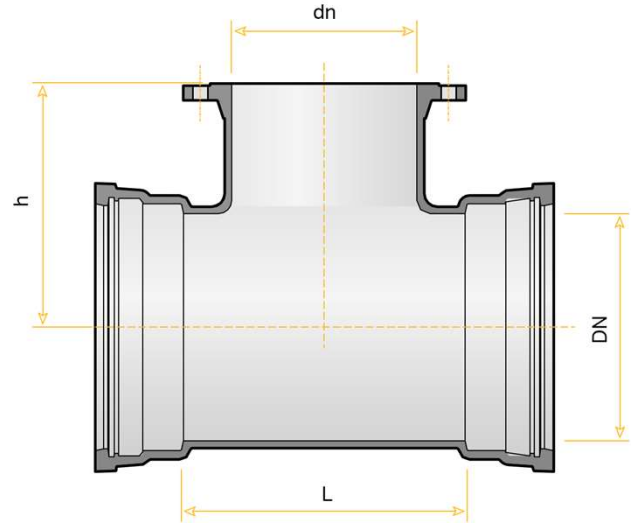

DIMAX DUCTILE IRON DN80-300 AS/NZS 2280 FITTINGS

Spigot x Flange Tees



NOMINAL SIZE		Dimensions	
BODY DN	BRANCH dn	h	L
100	80	178	432
100	100	178	432
150	100	203	432
150	150	203	432

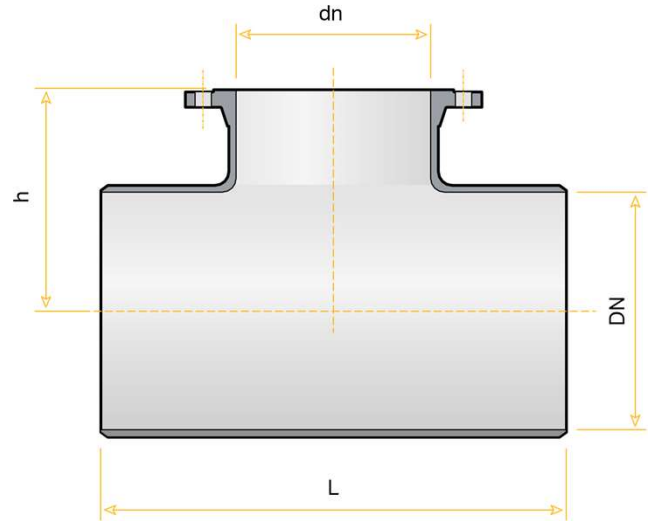

DIMAX DUCTILE IRON DN80-300 AS/NZS 2280 FITTINGS

TYTON® Socket x Spigot x Flange Tees



NOMINAL SIZE		Dimensions		
BODY DN	BRANCH dn	c	h	L
100	80	105	195	310

dn

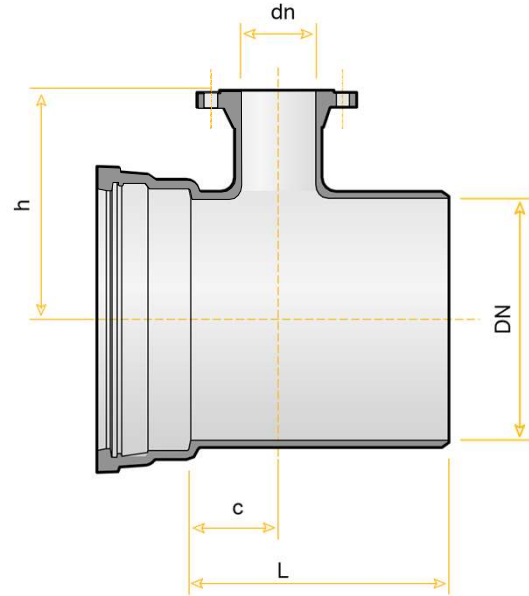

DIMAX DUCTILE IRON DN80-300 AS/NZS 2280 FITTINGS

Flange Dimensions to AS/NZS 4087
Dimensional Data



Class 16

NOMINAL SIZE DN	Flange Dimensions					Bolting Details (to AS/NZS 4087)			Neck Dimensions		
	Diameter D	Thickness T	Raised Face Diameter F	Raised Face Height t	Pitch Circle Diameter P	Number of Holes N	Diameter of Holes V	Fastener Size and Thread	Large End Diameter C	Small End Diameter H	Min Length of Taper G
80	185	18	122	3	146	4	18	M16	106	100	8
100	215	20	154	3	178	4	18	M16	136	126	11
150	280	23	211	3	235	8	18	M16	188	181	11
200	335	23	268	3	292	8	18	M16	243	236	12
225	370	24	300	3	324	8	18	M16	275	263	19
250	405	24	328	3	356	8	22	M20	307	290	26
300	455	30	378	4	406	12	22	M20	354	349	28
375	550	33	463	4	495	12	26	M24	439	430	30
450	640	33	552	4	584	12	26	M24	528	511	33
500	705	35	609	4	641	16	26	M24	581	564	34
600	825	42	720	5	756	16	30	M27	689	671	38
750	995	47	888	5	927	20	33	M30	855	830	53

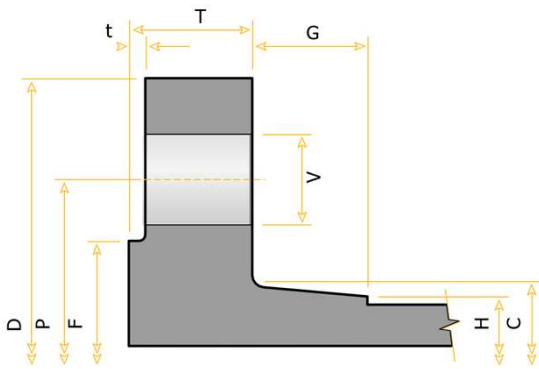

DISCLAIMER

All trademarks and logos are owned by The Reece Group. The words TYTON®, TYTON-LOK® and TYTON JOINT® are United States Pipe and Foundry Co. Inc. trademarks and are registered as such in the United States Patent Office and some 45 other countries. Viadux is an exclusively authorised and licensed user of these trademarks within Australia and New Zealand. All other brand or product names are trademarks or registered marks of their respective owners. Because we are continuously improving our products and services, The Reece Group reserves the right to change specifications without prior notice.

Call 1800 032 566 or visit www.reece.com.au/storefinder for your nearest branch.

CERTIFICATIONS

AS/NZS 2280 – Ductile Iron Pipe and Fittings
AS/NZS 4020 – Testing of products for use in contact with drinking water
AS/NZS 4087 – Metallic flanges for waterworks purposes
AS/NZS 4158 – Thermal-bonded polymeric coatings on valves and fittings for water industry purposes
WSAA PA 1924