



1897
SHAW'S
ENGLAND

Handcrafted
for life

FIRECLAY SINK COLLECTION



IMPACT
RESISTANT



CHEMICAL
RESISTANT



DIRT & STAIN
RESISTANT



ODOUR
RESISTANT



HEAT-PROOF



LIFETIME
WARRANTY



WASTE DISPOSAL
COMPATIBLE



ANTIBACTERIAL

Shaws have been manufacturing fireclay sinks for over 100 years, using time honoured traditional methods and materials. Each handcrafted sink bears testament to the craftsmen who produce them.

Shaws sinks demonstrate the natural characteristics of fireclay ceramics and are created by a 'slip casting' process at our factory in the Lancashire town of Darwen. A mixture of clay and water is poured by hand into a porous mould. When the newly formed sinks are dry enough, craftsmen remove them from their moulds before hand finishing the sinks to create a smooth finish.

Following a gradual drying period of up to 40 hours, the sinks are then prepared with a ground coat before being glazed. Firing in specially designed kilns at temperatures of up to 1200 degrees centigrade completes this rigorous process. Whilst modern technology has improved manufacturing methods over the years, the principles of this handcrafted product remain the same.

Having taken two to three weeks to craft, each sink is proudly stamped with the impression of its maker and bears its own distinctive badge. Traditional craftsmanship is as important now as it was in 1897.



LANCASTER 610 SINGLE BOWL

FIRECLAY SINK



LANCASTER 840 SINGLE BOWL

FIRECLAY SINK

Round-edge single bowl sink. Includes 90mm Shaws branded polished chrome basket strainer. Compatible with waste disposal systems.

Code . 2029368

Dimensions . 610 x 460 x 255mm

Weight . 50kg

Total Capacity . 45L

- Hand moulded, heavy duty fireclay
- 0 taphole
- No overflow
- Lifetime replacement warranty

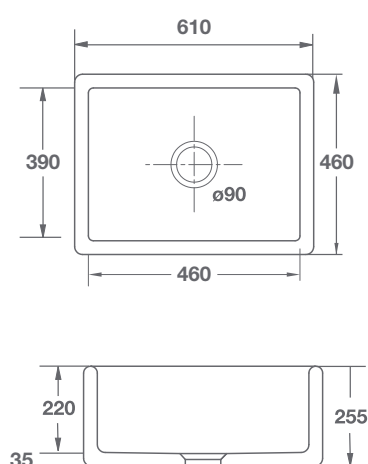

Round-edge generous single bowl sink. Includes 90mm Shaws branded polished chrome basket strainer. Compatible with waste disposal systems.

Code . 2029371

Dimensions . 838 x 457 x 255mm

Weight . 70kg

Total Capacity . 68L

- Hand moulded, heavy duty fireclay
- 0 taphole
- No overflow
- Lifetime replacement warranty

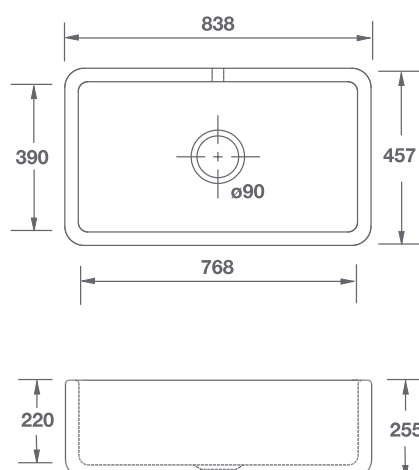

Reece Product Quality Guarantee

Shaws products enjoy a lifetime product replacement warranty.

For full warranty details visit www.reece.com.au/warranties

PLEASE NOTE: Our sink dimensions can vary by a plus or minus of 2%, as they are hand-made and shrink during firing. We therefore recommend that your kitchen fitter is aware of this and that **no work surfaces or cabinets are cut before measuring your individual sink**. Due to the handcrafted nature and weight of our sinks, we also recommend a specialist kitchen fitter installs your sink and that it is properly supported.



PRESTON 1000 DOUBLE BOWL

FIRECLAY SINK

Compact double bowl sink with dropped central dividing wall. Includes 90mm Shaws branded polished chrome basket strainers. Compatible with waste disposal systems.

Code . 2029369

Dimensions . 995 x 465 x 229mm

Weight . 75kg

Total Capacity . 69L each bowl

- Hand moulded, heavy duty fireclay
- 0 taphole
- No overflow
- Lifetime replacement warranty

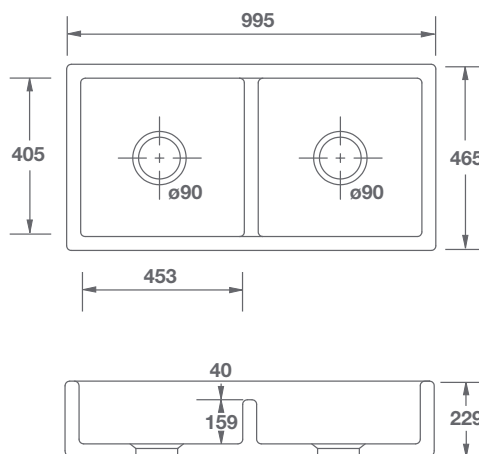

Bathroom Happiness

Visit any one of our 300 showrooms around Australia for all the latest products, concepts and inspiration to make your bathroom whatever you want it to be. And for the ultimate bathroom experience, go to one of our new bathroom life™ stores where you will find the biggest range of leading Australian and international brands.

AUS: Call 1800 032 566 or visit reece.com.au **NZ:** visit reece.co.nz

Due to limitations in the printing process the colours in this brochure are a guide only. The manufacturer/distributor reserves the right to vary specifications or delete models from their range without prior notification. The manufacturer/distributor takes no responsibility for printing errors. Shaws sinks are covered by a lifetime product replacement warranty - domestic use only. See www.reece.com.au/warranties for more information.

V4 [BROCHURE CODE 9503549]

