

Scala Nova Sink Mixer Pull Out Spray

SUSSEX

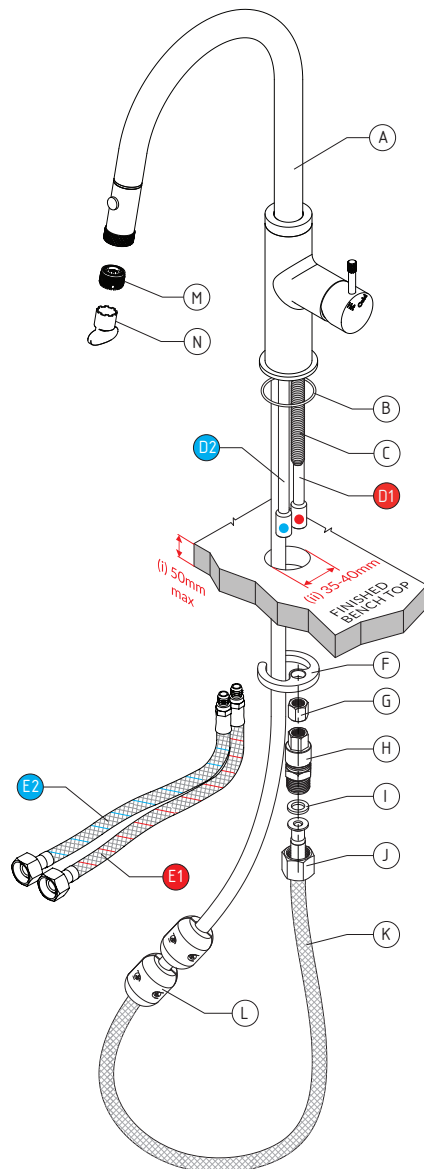

Product code

SNSMPOS.01

Install Preparation:

- The Mixer is supplied pre-assembled, the Fixing Nut (G), Weights (L) and Clamp (F) need to be temporarily removed prior to installation
- Maximum bench thickness is 50mm (i).
- Outlet Clearance Hole: 35 - 40mm (ii).
- Mounting Surface must be flat and level.
- Ensure adequate cupboard space has been provided to allow the Pull-out hose to move freely.

Product parts:

- (A) Outlet Assembly (Preassembled)
- (B) O-Ring
- (C) Thread Bar
- (D) Flexible hose extensions with M10 connections (D1= HOT and D2 = COLD)
- (E) Flexible hoses with 1/2" BSP Fittings with Conical Seals (E1= HOT and E2 = COLD)
- (F) Clamp
- (G) Fixing Nut
- (H) Dual Check Valve (DCV)
- (I) Swivel Hose Gasket
- (J) Swivel Nut
- (K) Pull-out Hose
- (L) Weights
- (M) Aerator
- (N) Aerator Key

Plumbers note:

- Tapware is to be installed by a Licensed Plumber in accordance with AS/NZS 3500:2021
- Recommended working water pressure 300 - 500 Kpa. Maximum water temperature is 65°C
- After installation, ensure that tapware functions correctly without leaks.
- Please ensure a copy of the Installation Instructions are left with the end user for future reference.



While we aim to ensure the specifications shown are correct at time of printing, Sussex Taps reserves the right to make modifications without prior notice. Always use the physical product for accurate measurements. Dimensions are subject to change without notice. All measurements are shown in millimetres. This product complies with lead free requirements.

Step 1

With the Fixing Nut (G), Weights (L) and Clamp (F) removed, pass the Pull-out Hose (K) through the mounting surface hole, lowering the Sink Mixer Assembly (A) onto the mounting surface. Working from underneath, fit the Clamp and Fixing Nut onto the Thread Bar (C) while compressing the O-ring (B) between the Sink Mixer and the finished bench surface.

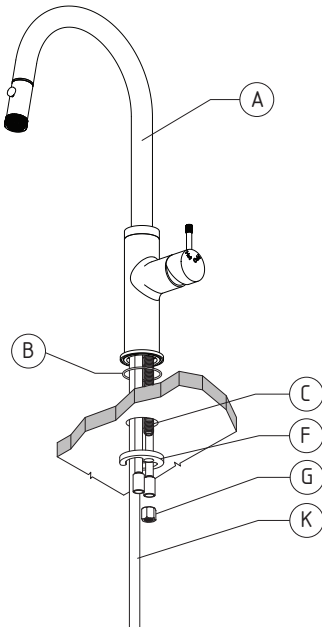

Step 2

Gently bend the Flexible Tail Extensions (D1 & D2) away from the Thread Bar and Pull-out Hose. Then connect the Hot (E1) and Cold (E2) flexible hoses under the bench. Tighten by hand, ensure the O-rings on the flexible hoses are properly seated.

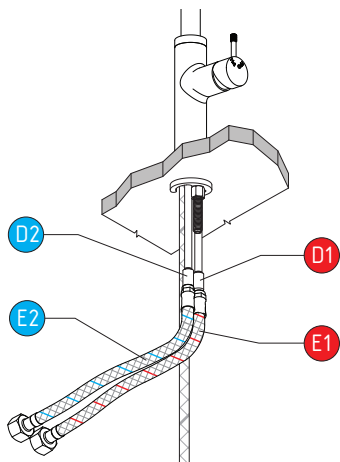

Step 3

Observe the Flow Direction Arrow on the DCV, attach the DCV Assembly (H) to the Thread Bar. The DCV has an O-ring to seal the Thread Bar. Connect the Pull-out Hose (K) to the DCV (Ensure the Swivel Hose Gasket (I) is intact and seated inside the swivel nut (J)). Re-attach the Weights (L) to the Hose, adjust the height of the weights if necessary. The maximum recommended length of Nozzle pull-out is approximately 400mm.

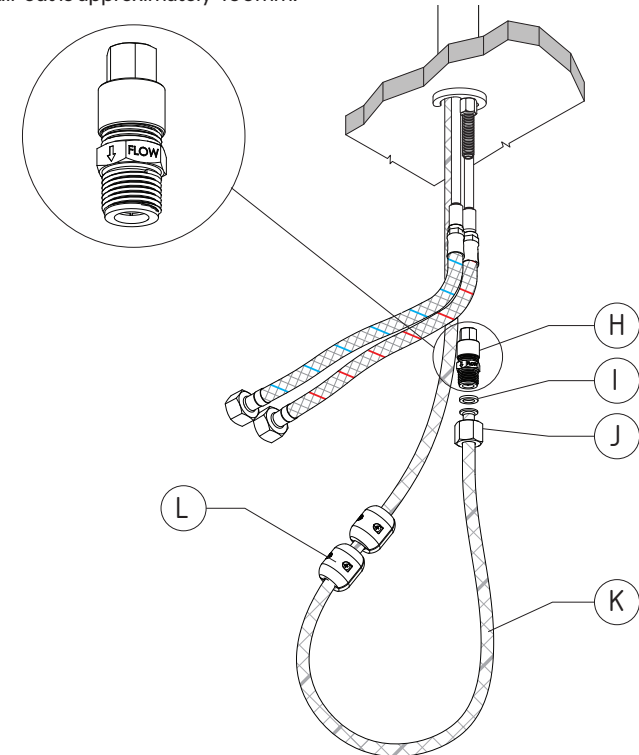

Step 4

Connect the Hot (E1) and Cold (E2) flexible hoses to 1/2" BSP pipework and tighten firmly with a spanner. Ensure hoses do not twist or kink during tightening. Sussex recommends using Stop Cocks/Mini Stops, however, these are not supplied. Test Mixer and Outlet function, check for leaks.

