

# posh

**Installation Instructions**

## Posh Solus MK2 Low Level Toilet Suite

### INSTALLATION INSTRUCTIONS

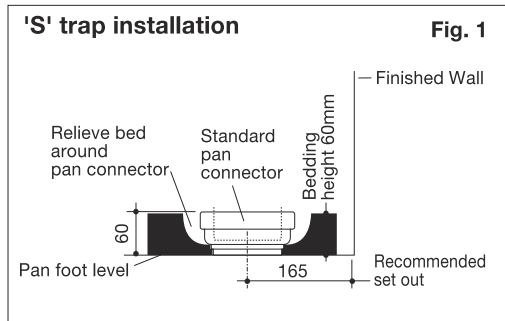

**IMPORTANT:** ALL DIMENSIONS ARE TO THE UNDERSIDE FOOT LEVEL OF THE PAN. IT IS IMPORTANT TO MAKE A HEIGHT ALLOWANCE FOR BEDDING.

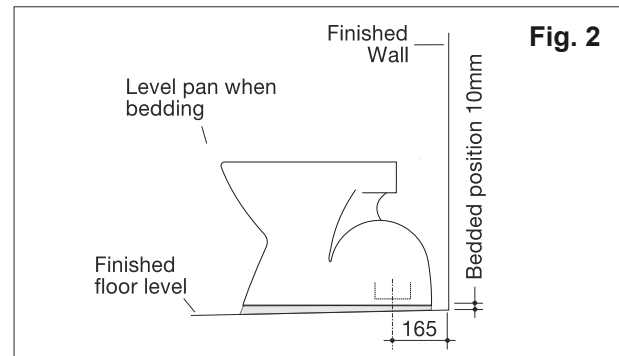

VITREOUS CHINA

### PAN FIXING PROCEDURE

#### Rough-in Procedure

The DWV waste pipe and pan collar should be accurately fixed into position as detailed in **Figure 1**.

#### Pan Bedding:

1. Remove an area of tiles which are within the internal area covered by the foot of the pan to expose the subfloor to provide a bondage key for the bedding mixture.
2. Ensure that bedding area is clean and free of building material.
3. Prepare bedding sand cement mixture 3:1 to depth of 60mm as detailed in **Figure 1**.

#### Note:

Do not fill the foot of the pan with bedding mix or include lime or fast drying cement in the mix, these may cause cracking in the foot of the pan.

4. Position pan and connect with pan connector then level pan into bedding mixture, so that the back of the foot of the pan is approximately 10mm above the finished floor as detailed in **Figure 2**. It is recommended that wedges are used to support the foot of the pan during the positioning.

#### SCREW FIXING:

1. Position pan onto pan connector. Adjust pan position if necessary and mark location of pan fixing holes on the floor. Remove the pan.
2. Drill holes in the marked positions on the floor. The hole diameter is dependent on the type of fixing system and floor finish.

#### IMPORTANT:

DO NOT USE THE PAN SCREW HOLES AS A GUIDE FOR DRILLING AS THIS MAY CRACK THE PAN.

3. Ensure that the area around the floor is clean and free from building material.
4. Run a bead of acetic cured silicone sealant at a height of 8mm approximately fully around the foot of the pan which contacts the floor. Use wedges around the foot base (if required) so that the maximum height of silicone sealant is not greater than 5mm on completion on bedding.
5. Connect pan to pan connector and fix to the floor with suitable corrosion resistant screws. Apply silicone sealant around pan base. Remove any excess sealant.

Dimensions are nominal measurements only.

**Plumbers, please ensure a copy of the installation instructions is left with the end user for future reference.**

Published 27/08/2020



## Posh Solus MK2 Low Level Toilet Suite

### INSTALLATION INSTRUCTIONS

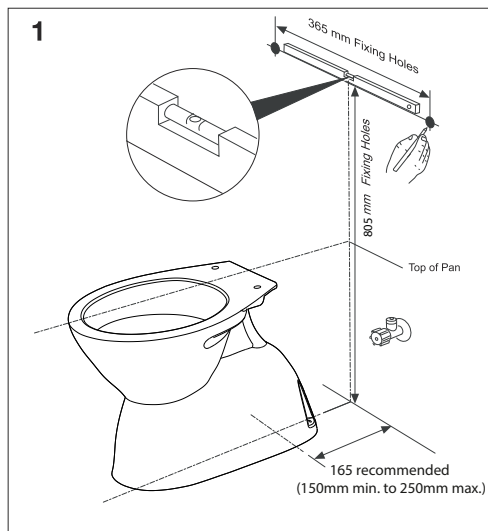

Check that the pan is installed within dimensional tolerances. Mark out the fixing holes for the cistern.

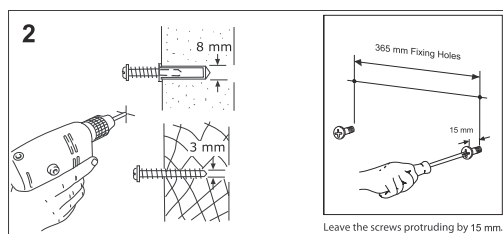

In masonry, drill 8mm diameter holes and insert the plugs provided. In timber, drill 3mm diameter pilot holes.

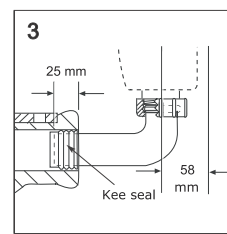

Cut the flush pipe to dimensions shown. Lubricate the kee seal with soap and water and fit the pipe into the pan. Fit the coupling nut and seal onto the flushpipe.

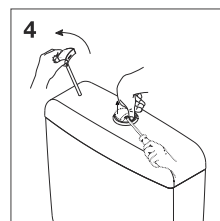

Push one of the knobs and release the other one from the cistern lid as shown.

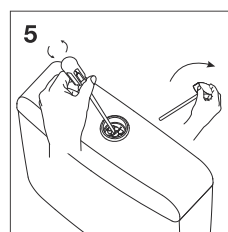

Unscrew the anti-vandal screw from the socket as shown.

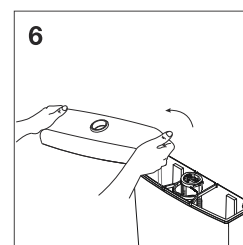

Remove the lid from the cistern.

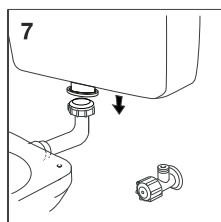

Lower the cistern onto the pipe and hook it over the mounting screws.

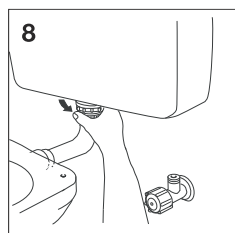

Hand tighten the coupling nut.

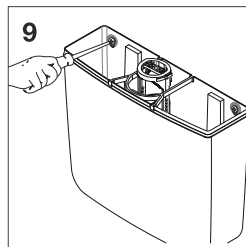

Nip up the mounting screws.

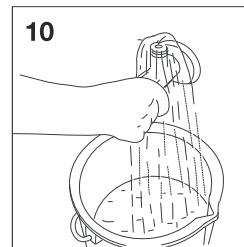

Flush the water supply line.

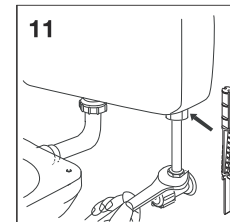

Make sure that the strainer is in place. Then fit the water supply pipe using approved fittings.

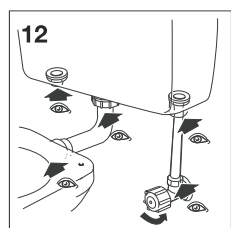

Turn on the water. Operate the cistern and check for leaks.

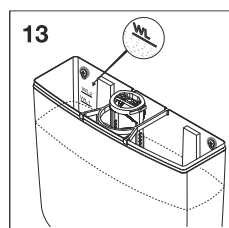

Water level marking (Factory setting) 4.5/3L. Adjustable to 6/3 Litres if required.

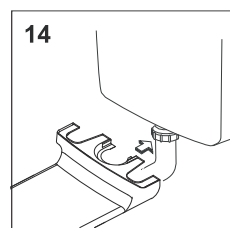

Push the link plate into position for marking.

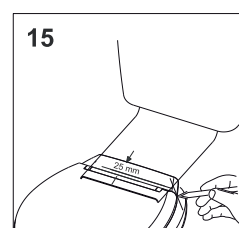

Position the seat and mark the link plate as shown.

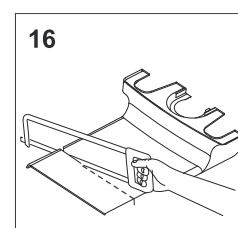

Cut the excess length of link along the guide recess provided at the bottom of link.

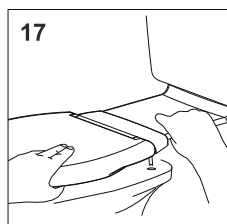

Push the link plate back into place and seat bolts into pan holes. At same time, locate and push flush pipe into pan outlet.

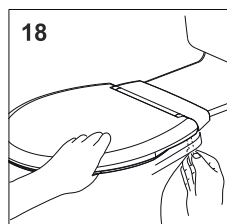

Tighten seat bolt nuts to firmly locate seat.

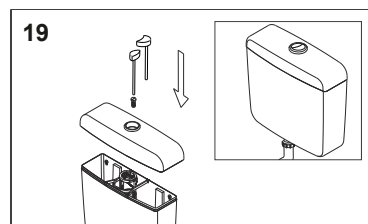

Carefully refit the lid.

Dimensions are nominal measurements only.

**Plumbers, please ensure a copy of the installation instructions is left with the end user for future reference.**

Published 27/08/2020