

# FORMA WALL BASIN 500MM

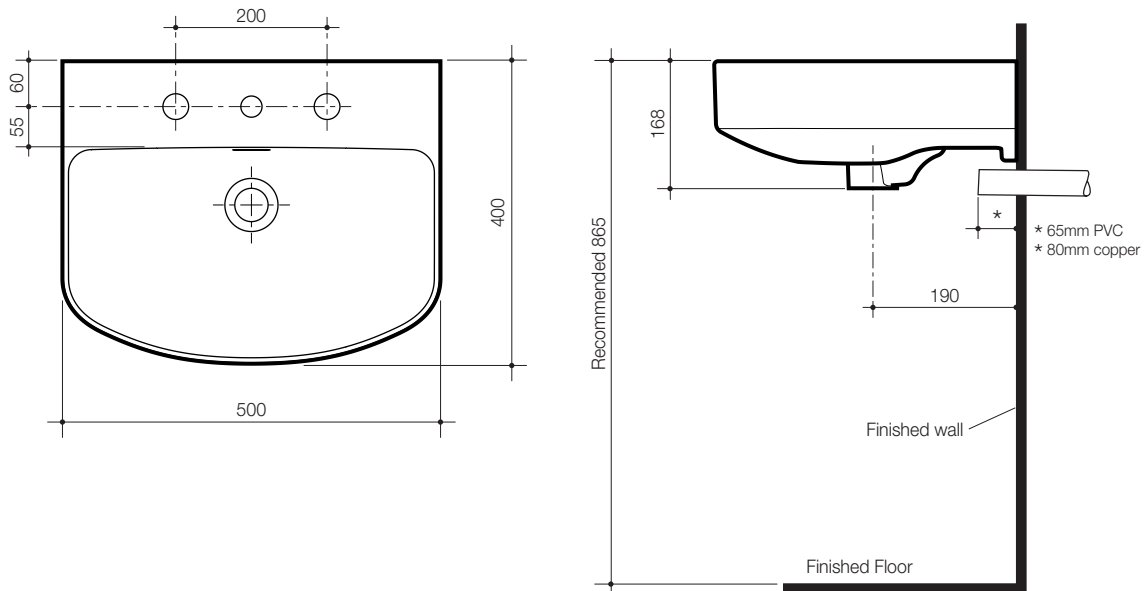

## SPECIFICATIONS

<b>Recommended use</b>	Domestic, hotel and commercial.
<b>Material</b>	Ceramic.
<b>Tap holes</b>	0 tap holes, 1 tap hole and 3 tap hole options.
<b>Plug and waste</b>	Chrome flush fitting waste and white plug (supplied); suitable for a 40mm trap connection.  Alternative waste options are available - Chrome grate waste and white plug, vandal resistant flush fitting plug and chrome waste, covered plug and waste and vandal resistant covered chrome plug and waste (sold separately).
<b>Shroud</b>	Forma shroud 9507992 (optional).
<b>Bowl capacity</b>	5.2 litres to overflow.
<b>Overflow</b>	Overflow available only. Designed for maximum tap flow rate of 15 litres/minute.
<b>Fixing</b>	D.200 basin fixing kit (supplied).
<b>Colour availability</b>	White.
<b>Tapware</b>	Sold separately



To see the complete FORMA range go to [www.reece.com.au/bathrooms](http://www.reece.com.au/bathrooms)

## CLEANING RECOMMENDATIONS

This bathroom product should not be cleaned with abrasive materials eg. steel wool/scourers. Do not use any corrosive or abrasive cleaning agents containing acids or scouring agents. Bleaches can also discolour products and therefore should not be used. Damage caused by any improper treatment is not covered by the product warranty - refer to Warranty Conditions.

# FORMA WALL BASIN 500MM

## INSTALLATION INSTRUCTIONS

**IMPORTANT:** Provide suitable reinforcement behind finished wall for the basin D.200 Fixing at the fixing height position.

**Roughing in for D.200 Fixing Kit:** For timber stud walls, noggins and studs must be positioned at a height to allow for the location of fasteners as detailed below.

**Note:** It is essential for the installation of the optional shroud to the basin that clearance is provided for the shroud in the plumbing setout from water inlet pipes and connections. Refer to shroud installation instructions.

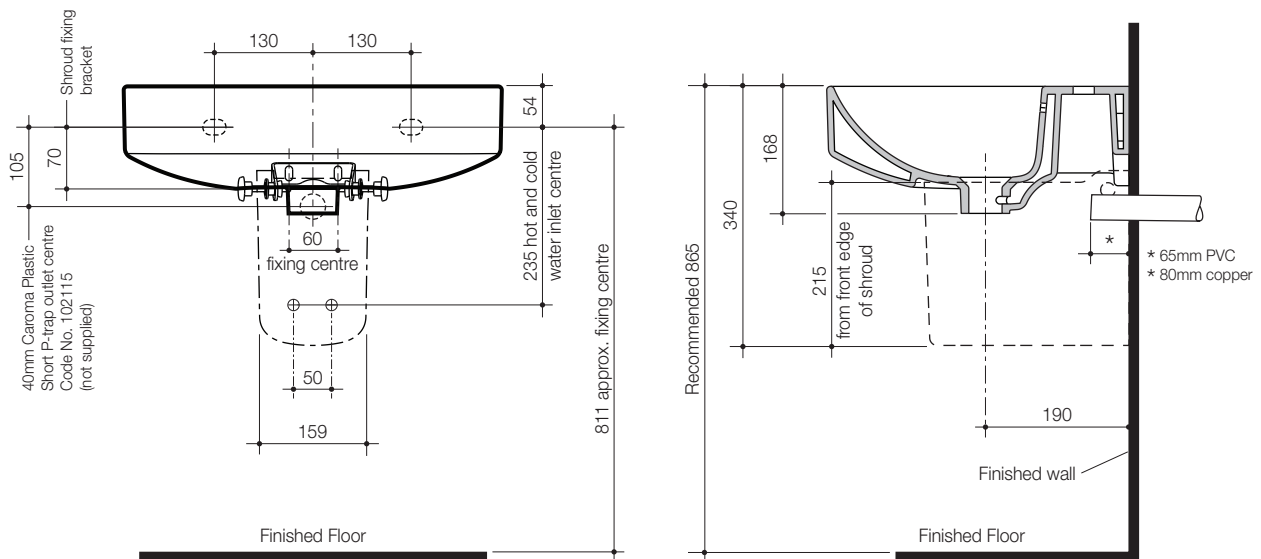

Forma Shroud 9507992 (optional)

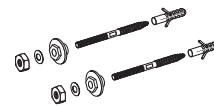
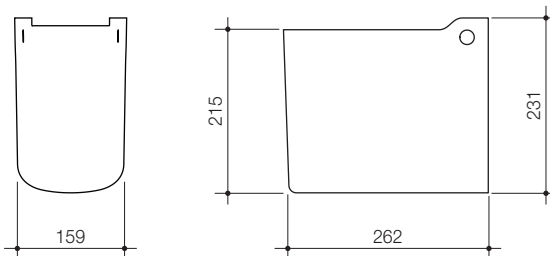

D.200 Basin Fixing Kit included with basin