

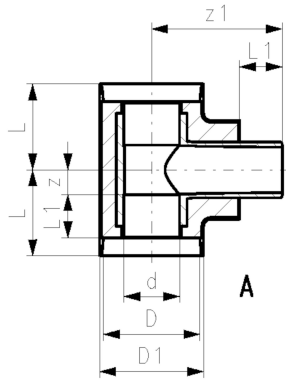

COOL-FIT 4.0 Tee 90° equal

Model:

- Pre-insulated PE100 SDR11, metric
- Insulation made from GF HE foam
- Outer jacket impact resistant. Colour: black
- Electrofusion Fitting with integrated sealing lip, for a water and vapour tight sealing



d/D (mm)	PN (bar)	Code	Weight (kg)	D1 (mm)	L (mm)	L1 (mm)	z (mm)	z1 (mm)	closest inch (inch)	Type
32/90	16	738 203 108	0.161	97	79	36	18	118	1	A
40/110	16	738 203 109	0.257	117	87	40	22	132	1 ¼	A
50/110	16	738 203 110	0.342	117	94	44	25	138	1 ½	A
63/125	16	738 203 111	0.514	132	103	48	30	154	2	A
75/140	16	738 203 112	1.000	147	116	55	36	168	2 ½	A
90/160	16	738 203 113	1.400	1668	130	62	43	187	3	A
110/180	16	738 203 114	2.500	188	154	72	57	207	4	A
160/250	16	738 203 117	5.600	258	192	90	77	263	6	A
225/315	16	738 203 120	16.748	324	355	110	220	337	8	A

The technical data are not binding. They neither constitute expressly warranted characteristics nor guaranteed properties nor a guaranteed durability. They are subject to modification. Our General Terms of Sale apply.

Georg Fischer Piping Systems Ltd, Postfach, CH-8201 Schaffhausen/Switzerland

Phone +41 -(0)52-631 1111

e-mail: info.ps@georgfischer.com

Internet: <http://www.gfps.com>