

AFA Sink Basket Waste Complete Plug & Waste Stainless Steel

Installation Instructions

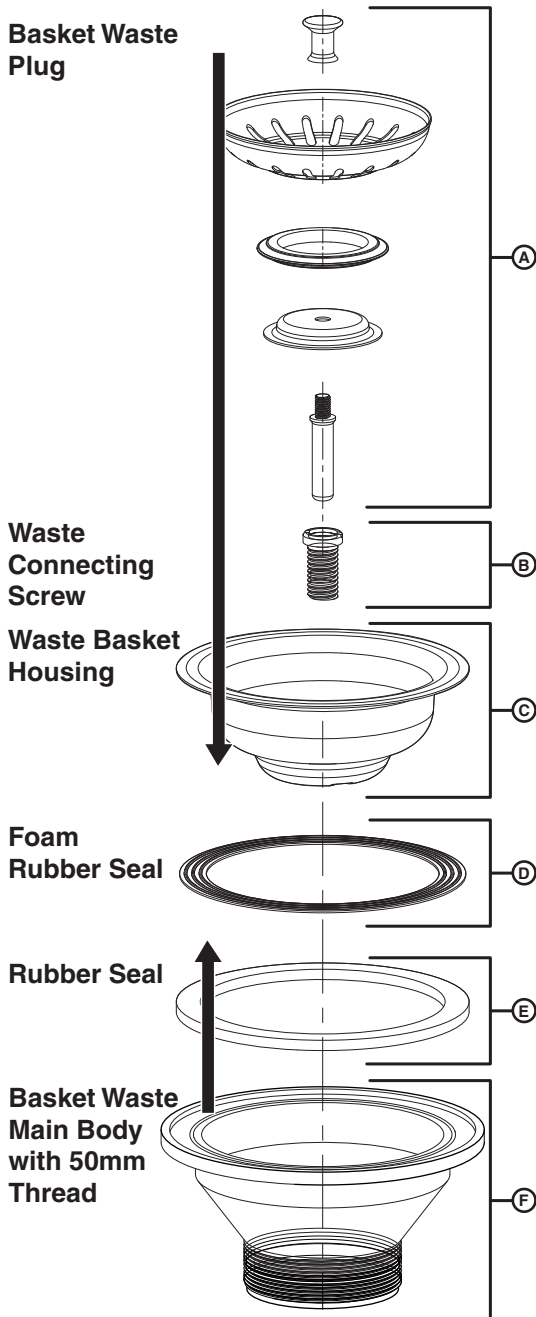

1. Ensure the sink /trough waste area where basket waste is to be fitted is to be fitted is clean and dry on both top and bottom surfaces.
2. Take assembled basket waste apart.
3. Place rubber seal **(D)** under rim of waste housing **(C)**
Alternately can use silicone under rim of instead of washer but ensure it is applied under entire rim.
4. Insert screw **(B)** through housing **(C)** and screw down until it engages with thread on main body. Continue to screw down till both housing **(C)** and main body **(F)** are pulled firmly together to create watertight seal
Do not overtighten.
Ensure the entire basket waste is centered to wastehole in sink/trough.
5. If any sealant has been used please ensure any excess is cleaned off
6. Once all plumbing is connected fill sink/trough and check for leaks .
Check that plug **(A)** is sealing adequately

Care Details

We recommend the use of soapy water or approved cleaners. This product should not be cleaned with abrasive materials. Damage caused by any improper treatment is not covered by the product warranty - refer to Warranty Conditions on the last page.

Plumbers, please ensure a copy of the installation instruction is left with the end user for future reference.