



Milli Axon Multi Towel Rails Swivel

SPECIFICATIONS

Recommended Use	Domestic, Commercial, Hotel
Colour	Chrome
Mounting	Wall Mounted
Towel Rail Type	Swivel
Material	Brass
Weight Capacity - Per Rail	5.0kg
Fixings	Double

WARRANTY

Warranty - Domestic Use	12 Months
Spare Parts & Labour	12 Months

Please refer to Warranty Page for full Terms and Conditions



Milli Axon Multi Towel Rail Swivel Small



Milli Axon Multi Towel Rail Swivel Large

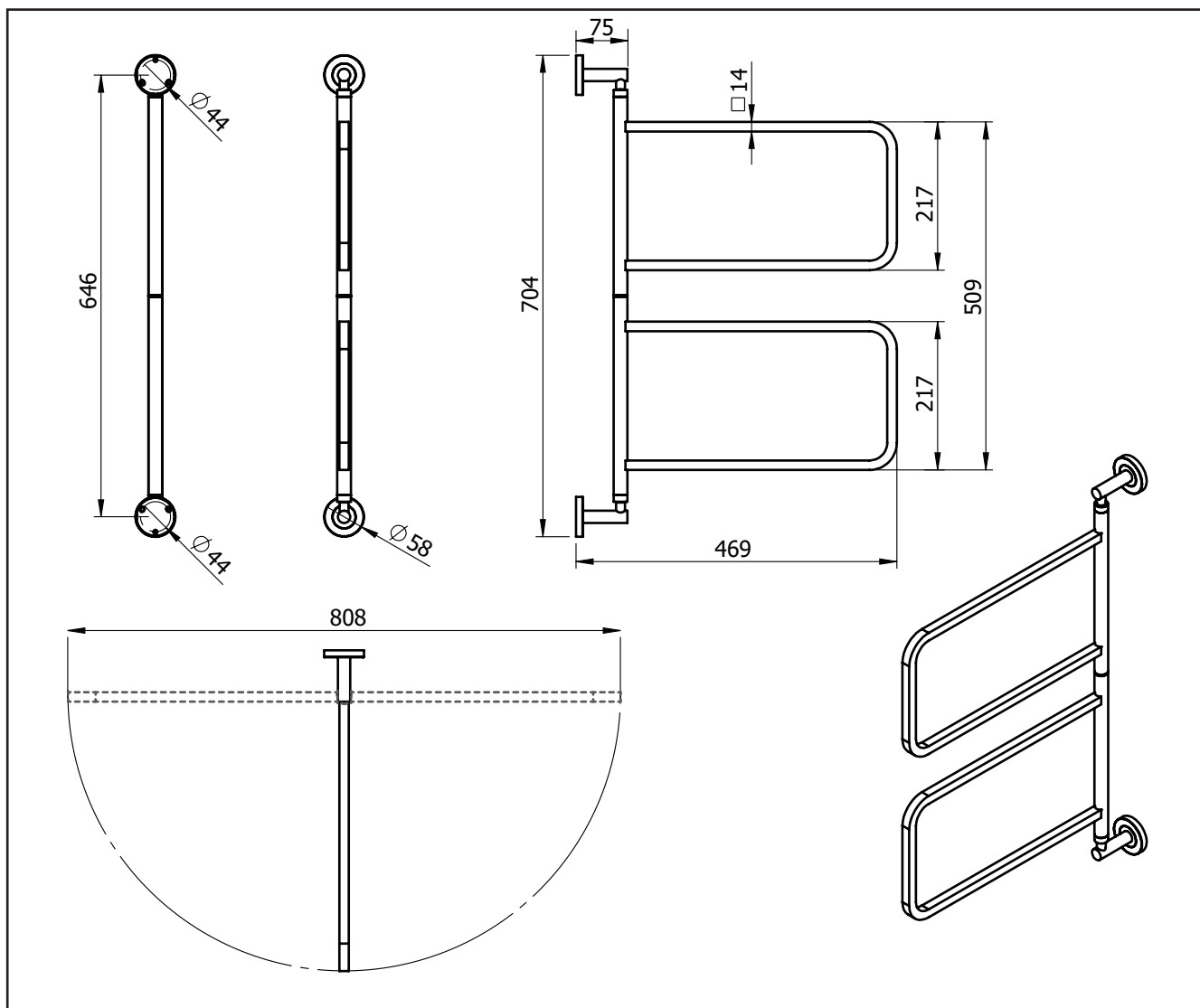

Milli Axon Multi Towel Rail Swivel Small

Disclaimer: Products in this specification manual must by regulation be installed by licensed and registered trade people. The manufacturer/distributor reserves the right to vary specifications or delete models from their range without prior notification. Dimensions are nominal measurements only. Dimensions and set-outs listed are correct at time of publication however the manufacturer/distributor takes no responsibility for printing errors.

Published 05/09/2019



Milli Axon Multi Towel Rails Swivel

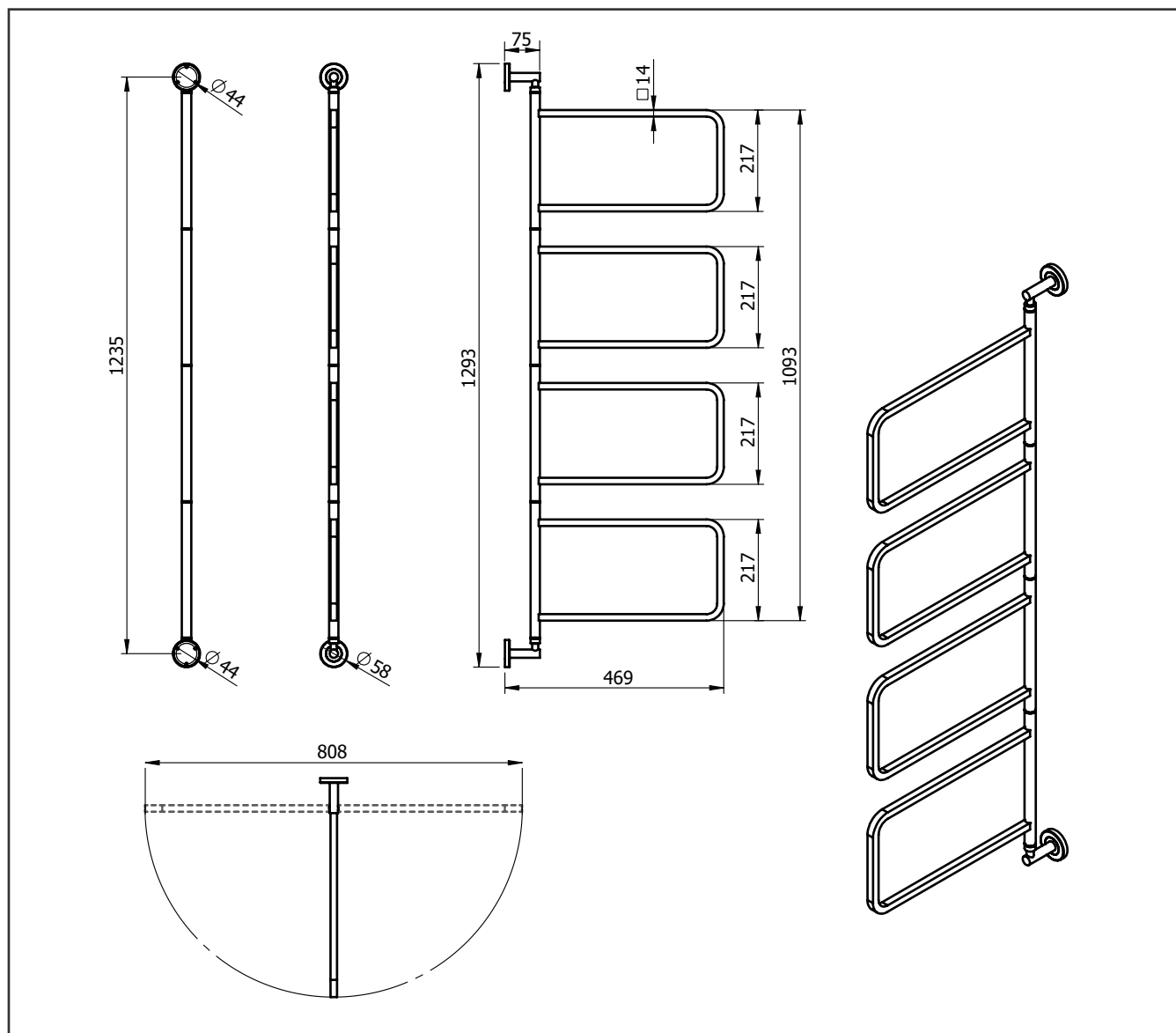

Milli Axon Multi Towel Rail Swivel Large

NOTE:

Wall materials vary. The accessory fixing kit supplied is suited for solid wall fixing. For timber framed walls, please ensure the accessory is fixed to a stud/noggin behind the wall. Where stud/noggin is not available, please use suitable hollow wall fixing.

CLEANING RECOMMENDATIONS:

We recommend the use of soapy water or approved cleaners. This product should not be cleaned with abrasive materials. Damage caused by any improper treatment is not covered by the product warranty. Refer to Warranty Conditions