

INSTRUCTIONS

Interchangeable Solid Core Filter Drier, series 4410

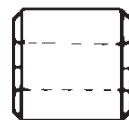

Cartridge
4490/A
4490/B

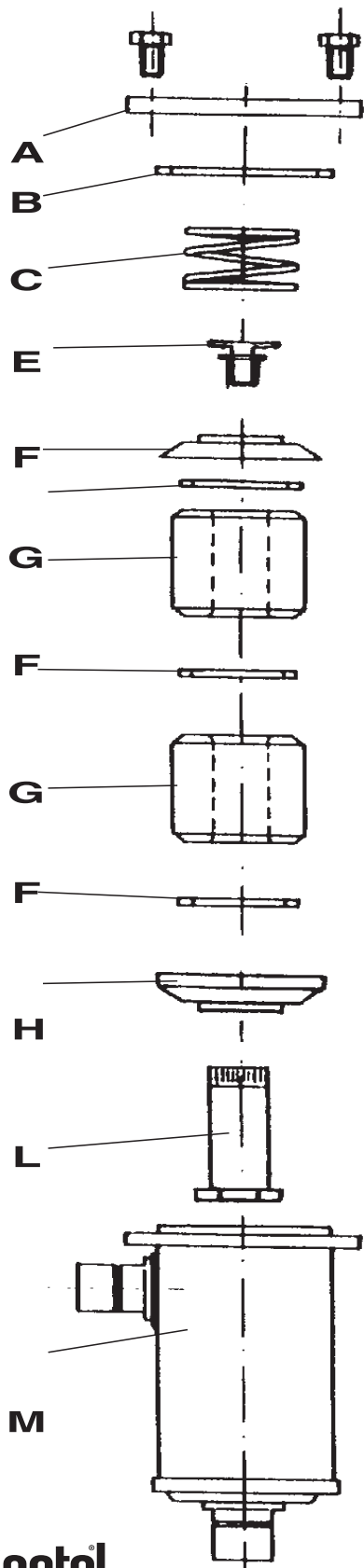
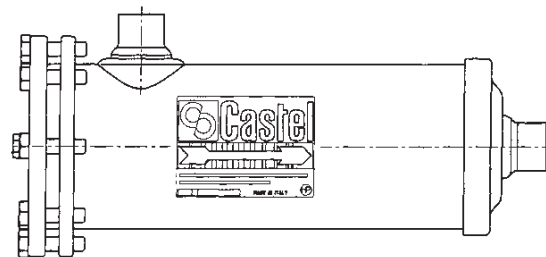

Before installing a refillable filter in a system it is necessary to carry out the following operations:

- Brazing the body "M" into the circuit
When soldering do not point the flame toward the filter body.

Once the body has been soldered into position, it is re-assembled in the following way:

- Screw the filtering tube "H" in to the red cup "L"
- Slide the gasket "F" on the filtering tube "H"
- Slide the cartridge "G" into the filtering tube "H"
- Slide the second gasket "F" on to position (in the case of 2 or more cartridges).
- Slide the second cartridge "G" into position
- Slide the last gasket "F"
- Place the plastic threaded cover "E" on the top of the last cartridge and screw it on the filtering tube "H" without forcing.
- Then slide the whole assembly into the main body "M" taking care that the cartridges do not scrape against the edge of the opening
- Place the spring "C" in position
- Lubricate with oil the gasket "B" and insert it in the proper way of the locking plate "A" and place the locking plate on the body "M"
- Insert the bolts and tighten, in crossed mode of 180° (31 N.m max torque)

N.B. - If the cartridges are exposed to atmospheric humidity, they lose their dehydrating potential! It is necessary to remove the protective wrapping only at the last minute!

- Every cartridge is supplied with spare gaskets "F"