

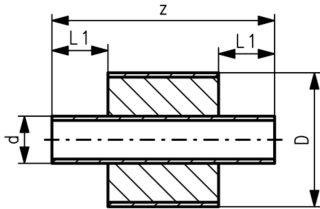

## COOL-FIT 4.0 Barrel nipple con aislamiento, d32-d225

### Model:

- Preaislado PE100 **SDR11/17** métrico
- Aislamiento hecho de espuma HE (GF)
- Chaqueta Exterior: Resistente al impacto y rayos UV Color: negro
- Para conexiones cortas entre accesorios COOL-FIT PE Plus Tipo A



d/D (mm)	PN (bar)	SDR	Part No.	weight (kg)	L1 (mm)	z (mm)	closest inch (inch)
32/90	16	11	<b>738 913 408</b>	0.126	36	151	1
40/110	16	11	<b>738 913 409</b>	0.188	40	155	1 ¼
50/110	16	11	<b>738 913 410</b>	0.226	44	163	1 ½
63/125	16	11	<b>738 913 411</b>	0.328	48	171	2
75/140	16	11	<b>738 913 412</b>	0.447	55	185	2 ½
90/160	16	11	<b>738 913 413</b>	0.631	62	199	3
110/180	16	11	<b>738 913 414</b>	0.929	72	219	4
160/250	10	17	<b>738 913 417</b>	1.576	90	255	6
225/315	10	17	<b>738 913 420</b>	3.254	110	295	8

The technical data are not binding. They neither constitute expressly warranted characteristics nor guaranteed properties nor a guaranteed durability. They are subject to modification. Our General Terms of Sale apply.

Georg Fischer Piping Systems Ltd, Postfach, CH-8201 Schaffhausen/Switzerland

Phone +41 -(0)52-631 1111

e-mail: [info.ps@georgfischer.com](mailto:info.ps@georgfischer.com)

Internet: <http://www.gfps.com>