



WOLFEN

INSTALLATION MANUAL

9509093 Wolfen Wall Hand Basin 500 x 420mm Less Brackets Right Hand 1 Tap Hole Stainless Steel

9509101 Wolfen Wall Hand Basin 500 x 420mm with Brackets Right Hand 1 Taphole Stainless Steel

2080239 Wolfen Slimline Wall Hand Basin 400 x 240mm with Brackets No Taphole Stainless Steel

2080240 Wolfen Slimline Wall Hand Basin 400 x 240mm with Brackets Left Hand 1 Taphole Stainless Steel

2080241 Wolfen Slimline Wall Hand Basin 400 x 240mm with Brackets Right Hand 1 Taphole Stainless Steel





WOLFEN™

CONTENTS

| | |
|---------------------------|-------|
| Intro | 02 |
| Technical Information | 03-05 |
| Installation Instructions | 06-07 |
| Maintenance/Cleaning | 07 |
| Warranty | 08 |

Delivering unrivalled quality

Designed for absolute performance, Wolfen's Wall Mounted Hand Basin sets new standards in quality and durability. Made from 304 Stainless Steel and to be fitted with 40mm Plug Waste. The Hand Basin is ideal for any domestic or commercial application.

TECHNICAL INFORMATION

| Model | Wolfen Wall Mounted Hand Basin 500x420 | Wolfen Wall Mounted Hand Basin 400x240 |
|-----------------|--|---|
| Product Code | 9509093 or 9509101 | 2080239, 2080240, 2080241 |
| Material | 304 Stainless Steel | 304 Stainless Steel |
| Thickness/Guage | 1.0mm | 1.2mm |
| Finish | Polished Stainless Steel | Brushed Stainless Steel |
| Tap Hole | 1 x Right Hand | 0, 1 x Right Hand, 1 x Left Hand |
| Waste | 40mm Plug Waste (sold seperately) | 40mm Plug & Waste (Sold Seperately) |
| Accessories | Mounting Bracket Sold Separately 9509093- Sold Separately 9509101 - Included | Mounting Bracket 2080239, 2080240, 2080241 -Included |

*****Not suitable for coastal environments***

Wolfen Wall Mounted Hand Basin



9509093 & 9509101



2080239, 2080240 & 2080241

TECHNICAL INFORMATION

Wolfen Wall Mounted Hand Basin

9509093, 9509101

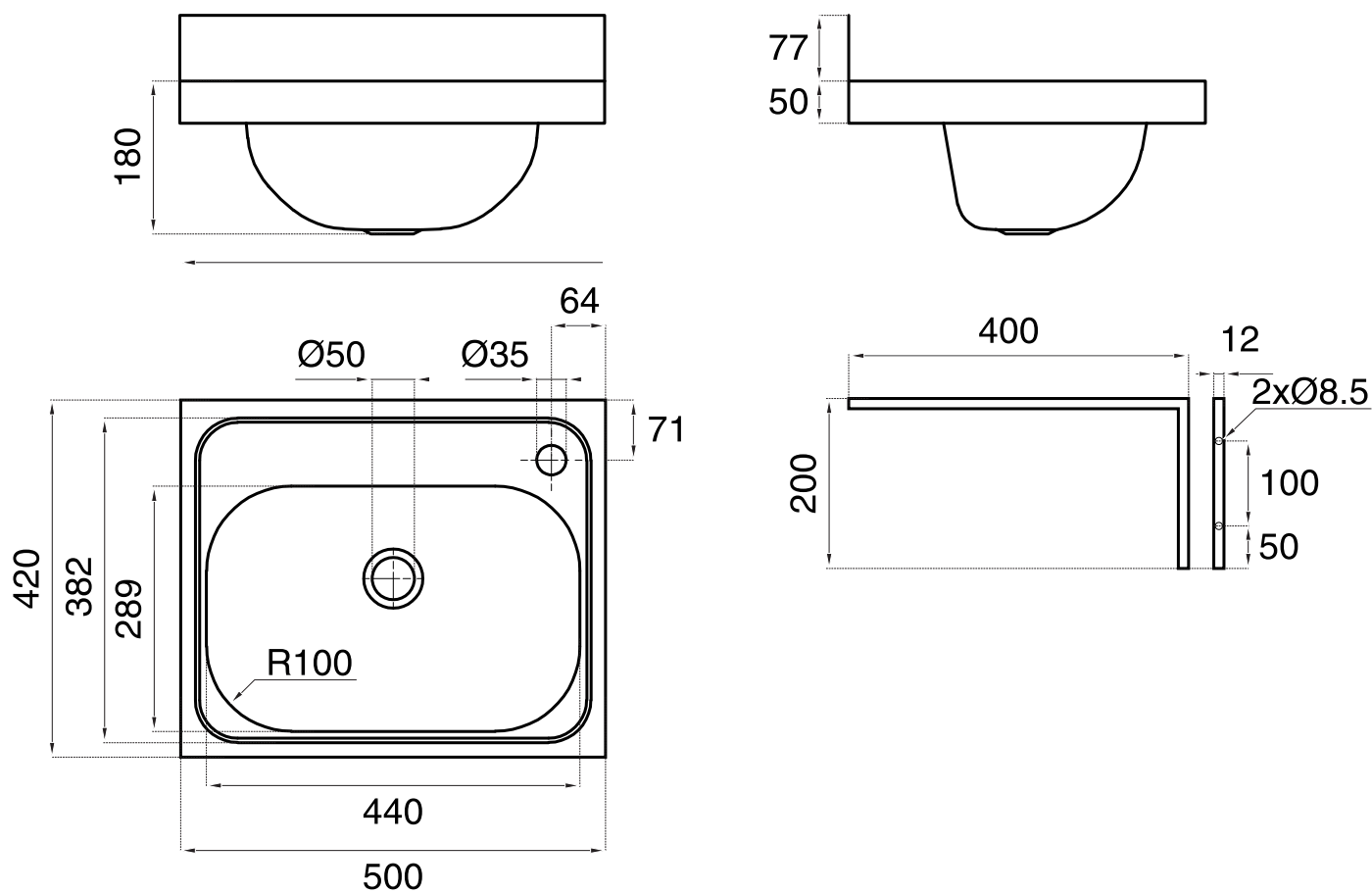

TECHNICAL INFORMATION

Wolfen Wall Mounted Hand Basin

2080239, 2080240, 2080241

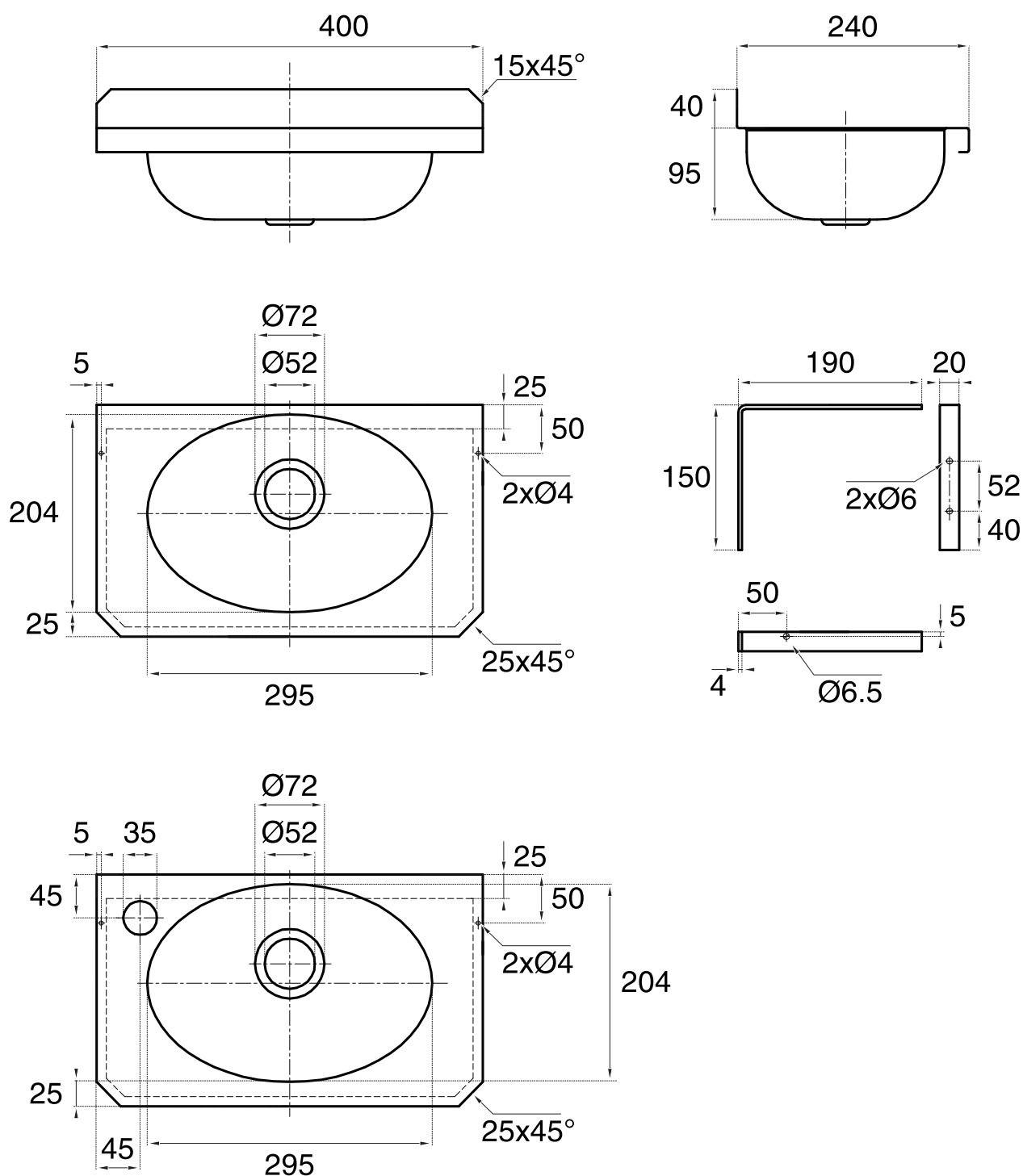

INSTALLATION INSTRUCTIONS

Fixing screws not provided. The appropriate screw type should be selected for either a solid wall or timber stud wall application.

If fixing to timber framed walls or partitioning the wall should be reinforced with a noggin in the appropriate location to receive fixing screws.

Wall Bracket Installation

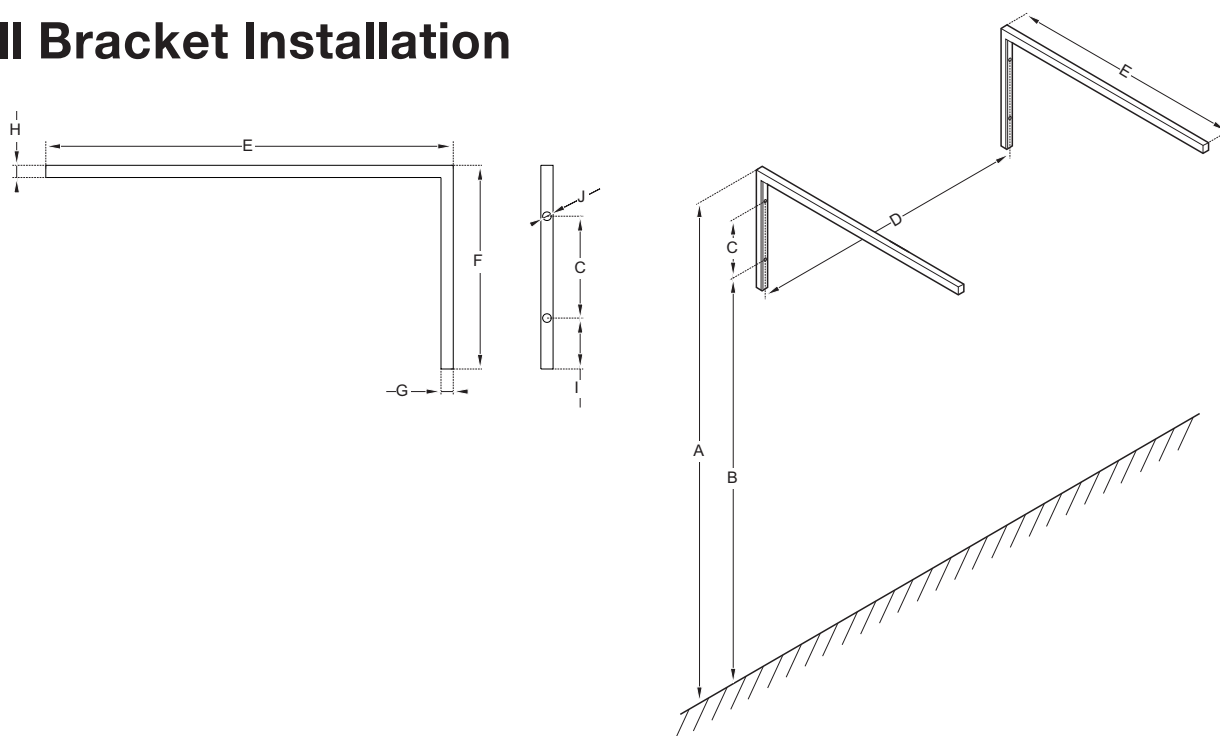

| Model | Wolfen Wall Mounted Hand Basin 500x420 (9509093) | Wolfen Wall Mounted Hand Basin 500x420 (9509101) | Wolfen Wall Mounted Hand Basin 400x240 (2080239) | Wolfen Wall Mounted Hand Basin 400x240 (2080240) | Wolfen Wall Mounted Hand Basin 400x240 (2080241) |
|-------------|--|--|--|--|--|
| Dimension A | 800 | 800 | 800 | 800 | 800 |
| Dimension B | 650 | 650 | 650 | 650 | 650 |
| Dimension C | 100 | 100 | 52 | 52 | 52 |
| Dimension D | 485 | 485 | 485 | 485 | 485 |
| Dimension E | 400 | 400 | 190 | 190 | 190 |
| Dimension F | 200 | 200 | 150 | 150 | 150 |
| Dimension G | 12 | 12 | 4 | 4 | 4 |
| Dimension H | 12 | 12 | 4 | 4 | 4 |
| Dimension I | 50 | 50 | 40 | 40 | 40 |
| Dimension J | 8.5Ø | 8.5Ø | 6Ø | 6Ø | 6Ø |

INSTALLATION INSTRUCTIONS

1. Mark bracket fixing points to achieve desired height.

Note: Recommended overall height is 800mm from top of sink to finished floor (see diagram to the left for fixing points)

2. Drill holes as marked and install first wall bracket with appropriate fixing screws

Note: Horizontal distance between fixing points is 485mm

3. Ensure that brackets have been installed parallel to each other and are level horizontally

4. Place Wolfen Hand Basin onto brackets

5. Install 40mm plug waste

6. Connect waste trap

CLEANING

We recommend the use of soap water or approved cleaners. This product should not be cleaned with abrasive materials. Refer to Stainless Steel Care & Cleaning with Maintenance document. Damage caused by any improper treatment is not covered by the product warranty. Refer to Warranty Conditions.

REECE PRODUCT QUALITY GUARANTEE



You have purchased a quality product from Reece Australia Pty Ltd ABN 84 004 097 090 ("Reece"). This product is covered by a 5 year replacement product warranty and a 12 month warranty over spare parts and labour.

5 Year Warranty

This warranty covers faults in the product construction, material and assembly. Products which are within 5 years from the date of purchase, found upon inspection by an authorised Reece representative, to be defective in construction, material or assembly, will be repaired or exchanged with an equivalent product free of charge. Replaced items become Reece's property.

All replacement products will be available for collection without charge to the customer at the nearest Reece branch to the customer's location, or elsewhere as agreed between the customer and Reece.

Labour And Spare Parts

The labour for the replacement of products and spare parts to which this warranty applies will be supplied by Reece or relevant supplier using licensed plumbers engaged by Reece or relevant supplier within 1 year from the date of purchase. Spare parts other than those listed in the Manufacturer's Provisions above, which are within 1 year from the date of purchase found upon inspection by an authorised Reece representative to be defective in construction, material or assembly, will be replaced free of charge.

Warranty Conditions

This warranty will apply only under all of the following conditions:

- The item has been installed by a licensed plumber
- Failure is due to a fault in the manufacture of the product
- Proof of purchase (including the date of purchase) is provided
- The installation of the product is in accordance with the instructions provided

This warranty does not cover products purchased as an ex-display without being fully checked and tested for sale by the manufacturer.

This warranty does not include faults caused by:

- Unsuitable or improper use. Incorrect installation or installation not in accordance with the instructions provided.
- Installation or part installation by the purchaser or any person other than a LICENSED PLUMBER.
- Inadequate or complete lack of maintenance. Chemical, electrochemical or electrical influences.
- Harsh detergents or abrasive cleaners used on product finishes

EXCLUSIONS

To the fullest extent permitted by law, Reece excludes all liability for damage or injury to any person, damage to any property, and any indirect consequential or other loss or damage.

For all warranty queries customers are to contact the branch where the product was purchased. These details can be found on your purchase invoice.

CLAIM PROCEDURE

Our goods come with guarantees that cannot be excluded under the Australian Consumer Law. You are entitled to a replacement or refund for a major failure and for compensation for any other reasonably foreseeable loss or damage. You are also entitled to have the goods repaired or replaced if the goods fail to be of acceptable quality and the failure does not amount to a major failure.

Don't risk it, use a licensed plumber.™

IF AFTER CHECKING THE
INSTALLATION INSTRUCTIONS
AND IMPORTANT
INFORMATION, THE PROBLEM
HAS NOT BEEN IDENTIFIED,
CUSTOMERS ARE TO
CONTACT THE BRANCH
WHERE THE PRODUCT WAS
PURCHASED. THESE DETAILS
CAN BE FOUND ON YOUR
PURCHASE INVOICE.

General contact details for
Reece are as follows:

Reece Australia Pty Ltd

57 Balmain Street

Cremorne VIC 3121

+61 3 9274 0000

admin@reece.com.au



WOLFEN™

reece.com.au/wolfen