



Engineering progress
Enhancing lives

REHAU PINC™

Push In. Connect.

NEW ZEALAND



www.myrehau.com
Valid from January 2026
Subject to technical modifications

It's REHAU

Fast. Simple. Reliable.

PINC™ is REHAU's innovative push-fit plumbing fitting range designed to make installations quicker and easier—without compromising on quality. With **no tools required**, installers save time, money and removes the hassle of bulky tools, while enjoying the confidence of a premium plumbing system.

Why Choose PINC™?

- **Tool-Free Installation:** Just push and connect – no maintenance, no calibration, no hassle.
- **Speed & Efficiency:** Complete installations in record time, reducing downtime.
- **Premium Performance:** Engineered for durability and safety, delivering long-term reliability.
- **Unmatched Safety:** PINC™ is considered the **most secure push-fit system on the market**, ensuring peace of mind for every connection.
- **REHAU Quality:** Backed by REHAU, trusted for excellence and precision.

Smart Features for Total Confidence

- **360° Fluorescent UV Pink Inspection Ring & Audible Click**
When you hear the *click* and see the full 360° fluorescent UV pink inspection ring, you know the joint is completely secure. This dual confirmation gives installers absolute trust in every connection.
- **Safety in Dark Places**
Working in low-light conditions? Shine a UV torch at the inspection ring to reveal a full-circle view of the completed joint—ensuring safety and accuracy even in hard-to-see spaces.

Compatibility & Sizes

- Available in **16 mm and 20 mm** sizes.
- Fully compatible with the **RAUTITAN PEX-A hot or cold piping system**, delivering a seamless solution for modern plumbing needs.



This Product Book must be used in conjunction with the latest RAUTITAN Technical Information Book. All handling, design, installation, testing, and operation of RAUTITAN products must comply with the requirements outlined in the RAUTITAN Technical Information Booklet

Fitting Components

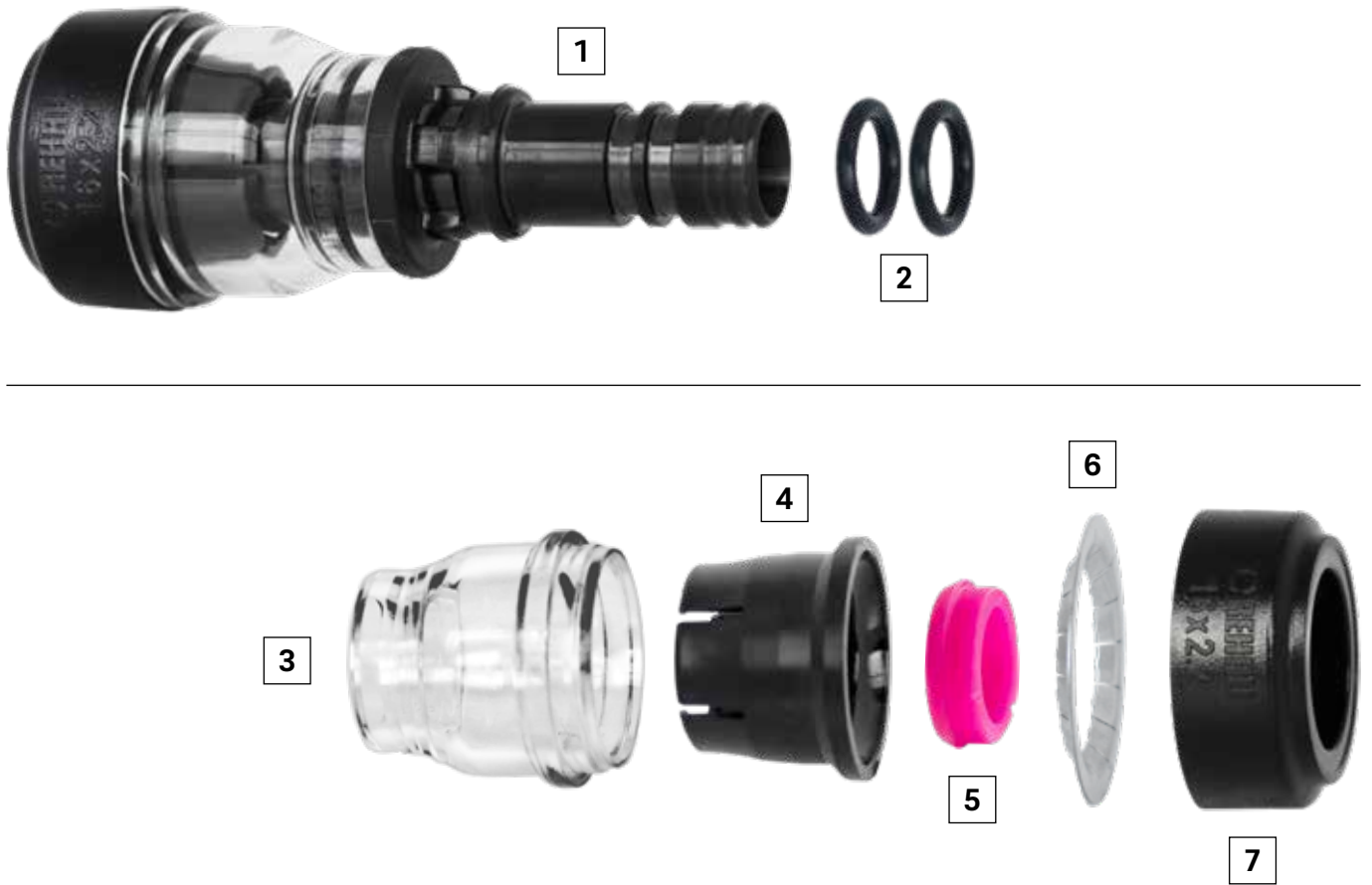

1. Fitting body

Made of temperature and chemical resistant engineered polymer, respectively REHAU's signature highly dezincification resistant brass.

2. Seal rings

2x EPDM seal rings for extra security and enhanced leak tightness.

3. Clear housing

Glass fibre reinforced transparent Grilamid. See what's going on inside from all directions.

4. Inner collet

Tough thermo-plastic polymer that provides both stability and strength to the fitting.

5. Guide ring

Dual functionality and the heart of the design - ensures smooth pipe insertion and provides visual confirmation of completed connection.

6. Grab ring

Stainless Steel toothed ring capable of holding up to 2.5 tonnes pull-out force.

7. End cap

Glass fibre reinforced black Grilamid. Securely holds all components in place.

REHAU PINC™

Product Range



PINC Straight Coupling

| REHAU Article Code | Size |
|--------------------|--------------------------|
| 442922 - 001 | PINC NO.1 COUPLING 16-16 |
| 442923 - 001 | PINC NO.1 COUPLING 20-20 |
| 442924 - 001 | PINC NO.1 COUPLING 20-16 |



PINC LF Elbow Male Thread

| REHAU Article Code | Size |
|--------------------|-----------------------------|
| 436872 - 001 | PINC LF NO.13 ELBOW 16-½"MI |
| 436874 - 001 | PINC LF NO.13 ELBOW 20-¾"MI |



PINC Elbow 90

| REHAU Article Code | Size |
|--------------------|---------------------------|
| 442925 - 001 | PINC NO.12 ELBOW 90°16-16 |
| 442926 - 001 | PINC NO.12 ELBOW 90°20-20 |



PINC LF Elbow Female Thread

| REHAU Article Code | Size |
|--------------------|-----------------------------|
| 436875 - 001 | PINC LF NO.14 ELBOW 16-½"FI |
| 436876 - 001 | PINC LF NO.14 ELBOW 20-¾"FI |



PINC Tee Piece

| REHAU Article Code | Size |
|--------------------|-----------------------------|
| 442917 - 001 | PINC NO.24 T-PIECE 16-16-16 |
| 442918 - 001 | PINC NO.24 T-PIECE 20-20-20 |
| 442919 - 001 | PINC NO.25 T-PIECE 20-16-20 |
| 442920 - 001 | PINC NO.26 T-PIECE 20-20-16 |
| 442921 - 001 | PINC NO.27 T-PIECE 20-16-16 |



PINC LF Elbow Female Wingback

| REHAU Article Code | Size |
|--------------------|--------------------------------|
| 436882 - 001 | PINC LF NO.15 BP ELBOW 16-½"FI |
| 436883 - 001 | PINC LF NO.15 BP ELBOW 20-¾"FI |
| 436884 - 001 | PINC LF NO.15 BP ELBOW 20-¾"FI |



PINC LF Straight Connector Female

| REHAU Article Code | Size |
|--------------------|------------------------------------|
| 436870 - 001 | PINC LF NO.2 STR CONNECTOR 16-½"FI |
| 436871 - 001 | PINC LF NO.2 STR CONNECTOR 20-¾"FI |



PINC LF Elbow Female Top Wingback

| REHAU Article Code | Size |
|--------------------|--------------------------------|
| 436886 - 001 | PINC LF NO.15 BP ELBOW 16-½"FI |



PINC LF Straight Connector Male

| REHAU Article Code | Size |
|--------------------|------------------------------------|
| 436868 - 001 | PINC LF NO.3 STR CONNECTOR 16-½"MI |
| 436869 - 001 | PINC LF NO.3 STR CONNECTOR 20-¾"MI |



PINC LF Elbow Male Parallel Thread

| REHAU Article Code | Size |
|--------------------|--------------------------------------|
| 436879 - 001 | PINC LF NO.19 BP ELBOW 16-G½"MI 65MM |
| 436880 - 001 | PINC LF NO.19 BP ELBOW 16-G½"MI 90MM |

Push Connectivity



PINC LF Stopper

| REHAU Article Code | Size |
|--------------------|--------------------------|
| 436877 - 001 | PINC LF NO.61 STOPPER 16 |
| 436878 - 001 | PINC LF NO.61 STOPPER 20 |



PINC LF Transition Straight Coupling

| REHAU Article Code | Size |
|--------------------|------------------------------------|
| 436897 - 001 | PINC LF NO.1 TRAN COUPLING 16-25RT |
| 436898 - 001 | PINC LF NO.1 TRAN COUPLING 20-25RT |

Transition to RAUTITAN compression sleeve system



PINC LF Straight Tap Connector With Gasket

| REHAU Article Code | Size |
|--------------------|--|
| 436894 - 001 | PINC LF NO.62 STR TAP CONN16-G½"FI W/GKT |

Integrated gasket seal, flat



PINC LF Transition Tee Piece

| REHAU Article Code | Size |
|--------------------|-----------------------------------|
| 436896 - 001 | PINC LF TRAN T-PIECE 25RT-20-25RT |

Transition to RAUTITAN compression sleeve system



PINC LF Straight Tap Connector

| REHAU Article Code | Size |
|--------------------|--|
| 436890 - 001 | PINC LF NO.62 STR TAP CONNECTOR 16-G½"FI |
| 436891 - 001 | PINC LF NO.62 STR TAP CONNECTOR 20-G¾"FI |

Integrated flexible seal, tapered



PINC LF Bent Tap Connector

| REHAU Article Code | Size |
|--------------------|--------------------------------------|
| 436887 - 001 | PINC LF NO.63 BENT TAP CONN 16-G½"FI |
| 436888 - 001 | PINC LF NO.63 BENT TAP CONN 20-G¾"FI |

Integrated flexible seal, tapered

PUSH PUSH
PUSH PUSH
PUSH PUSH
PUSH PUSH

REHAU PINC™

Do what really matters

REHAU Pty Ltd

National Customer Service Centre

Australia

Tel: 1300 768 033 • Fax: 1300 760 665

Email: sales.au@rehau.com

www.rehau.com.au

New Zealand

Tel: +64 9 272 2264

Email: sales.nz@rehau.com

www.rehau.co.nz



The information contained herein is believed to be reliable, but no representations, guarantees or warranties of any kind are made as to its accuracy, suitability for particular applications or the results to be obtained therefrom. Before using, the user will determine suitability of the information for user's intended use and shall assume all risk and liability in connection therewith.