

SUSSEX

Sussex Oria Sink Hob Mixer Set Pull Out Spray

Tapware is to be installed by a Licensed Plumber in accordance with AS/NZS 3500:2003
 Recommended working water pressure 300 - 500 Kpa. Maximum water temperature is 65°C

GENERAL NOTE

- The Mixer is supplied pre-assembled, the Clamping Ring (E), Clamps (F & I), Fixing Nut (J) and Weights (H) and need to be temporarily removed prior to installation.
- Maximum bench thickness is **50mm (i)**.
- Outlet Clearance Hole: **35 - 40mm (ii)**.
- Hob Mixer Clearance Hole: **48 - 50mm (iii)**.
- Minimum Distance between Outlet and Hob Mixer is **100mm (iv)** centre to centre.
- Mounting Surface must be flat and level.
- Ensure adequate cupboard space has been provided to allow the Pull-out hose to move freely.

PLUMBER'S NOTE

- On-site testing using higher water pressures must be conducted with the mixer in the closed position (static test).
- Under no circumstances is the mixer to be opened when exceeding the maximum stated water pressure.
- At completion of testing, do not relieve any high water pressure by operating the mixer.
- Exposing the internals of the Mixer Cartridge to higher than specified water pressures will void the manufacturer's warranty.
- Isolating Stop Valves are recommended with all installations (Not Included).
- Ensure all fittings and connections are secure and water-tight.

Part	Part Name
A	Outlet
B	Hob Mixer Assembly (Pre-assembled)
C	O-ring
D	Thread Bar
E	Outlet Clamping Ring
F	Clamp
G	Jacking Screws
H	Weights
I	Hob Mixer Clamp
J	Fixing Nut
K	Flexible hoses with 1/2" BSP Fittings with Conical Seals (K1= HOT, K2 = COLD and K3 = MIXED)
L	Dual Check Valve (DCV)
M	Swivel Hose Gasket
N	Swivel Nut
O	Pull-out Hose

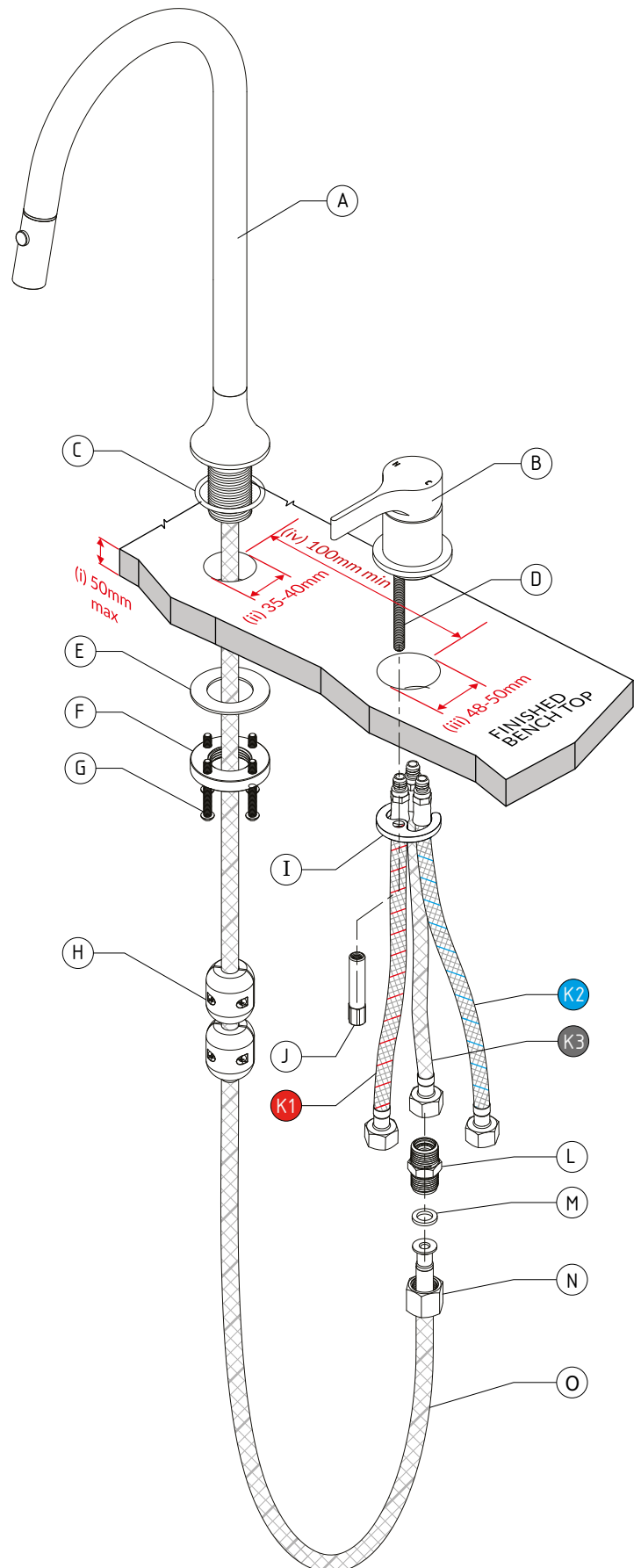

SUSSEX

Sussex Oria Sink Hob Mixer Set Pull Out Spray

1) For the Outlet (A), first remove the Clamping Ring (E), Clamp (F) and Weights (H) from the Pull-out Hose (O) then pass the Pull-out Hose and through the mounting surface. Working from underneath, fit the Clamping Ring and Clamp to the outlet's tail. Wind the clamp up as far as possible, then tighten the 4 Jacking Screws (G) to secure the Outlet. (tighten well).

For the Hob Mixer (B), remove Fixing Nut (J) and Clamp (I) then feed the preinstalled and labelled hoses (K1, K2 & K3) through the bench. Apply a small amount of Sealant to the under side of the Hob Mixer Flange to seal the Mounting Surface. Note: The "FRONT" label must be positioned to face the user. Working from underneath, fit the Clamp onto the Thread Bar (D) then tighten with Fixing Nut (J). (tighten well).

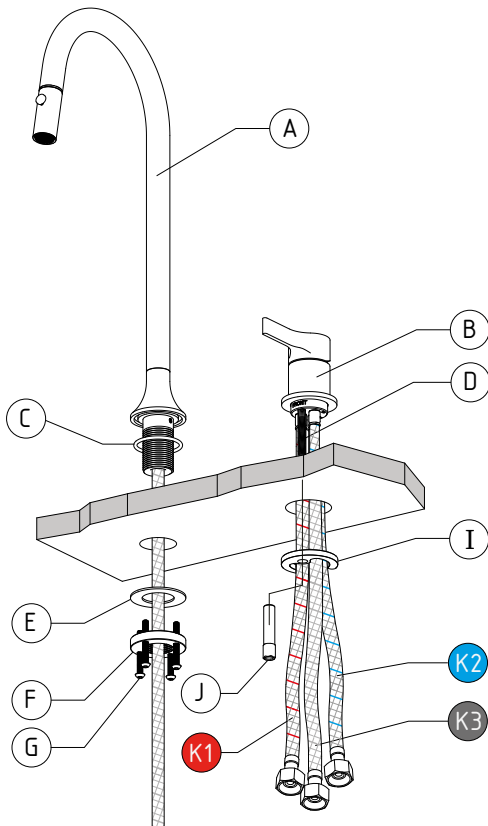

3) Connect the Hot (E1) and Cold (E2) flexible hoses to 1/2" BSP pipework and tighten firmly with a spanner. Ensure hoses do not twist or kink during tightening. Sussex recommends using Stop Cocks/Mini Stops, however, these are not supplied.

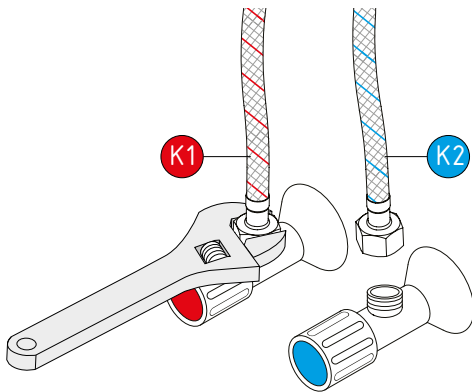

2) Observe the Flow Direction Arrow on the DCV, attach the DCV Assembly (L) to the Mixed Water Hose (K3). Connect the Pull-out Hose (O) to the DCV (Ensure the Swivel Hose Gasket (M) is intact and seated inside the swivel nut (N)). Re-attach the Weights (H) to the Hose, adjust the height of the weights if necessary. The maximum recommended length of Nozzle pull-out is approximately 400mm.

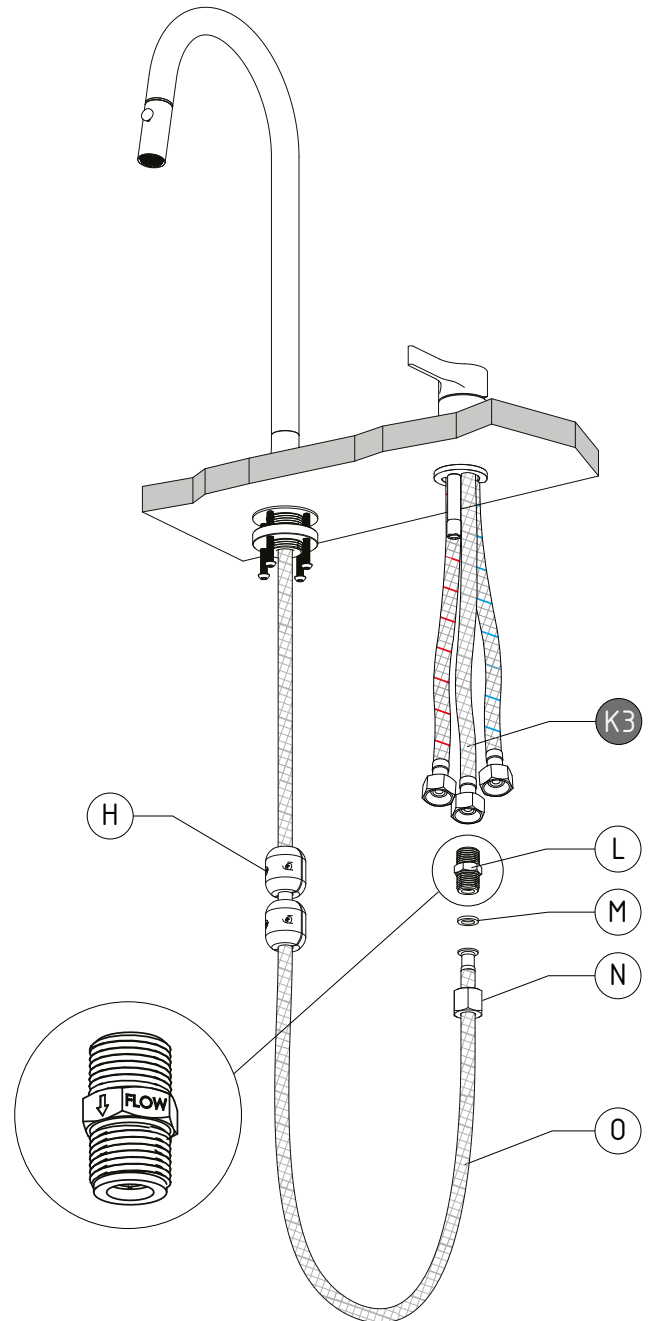

After installation, establish water supply and thoroughly check operation of tapware to ensure that it functions correctly and no water leaks. Plumbers, please ensure a copy of the Installation Instructions are left with the end user for future reference.